

# COLOR CODE

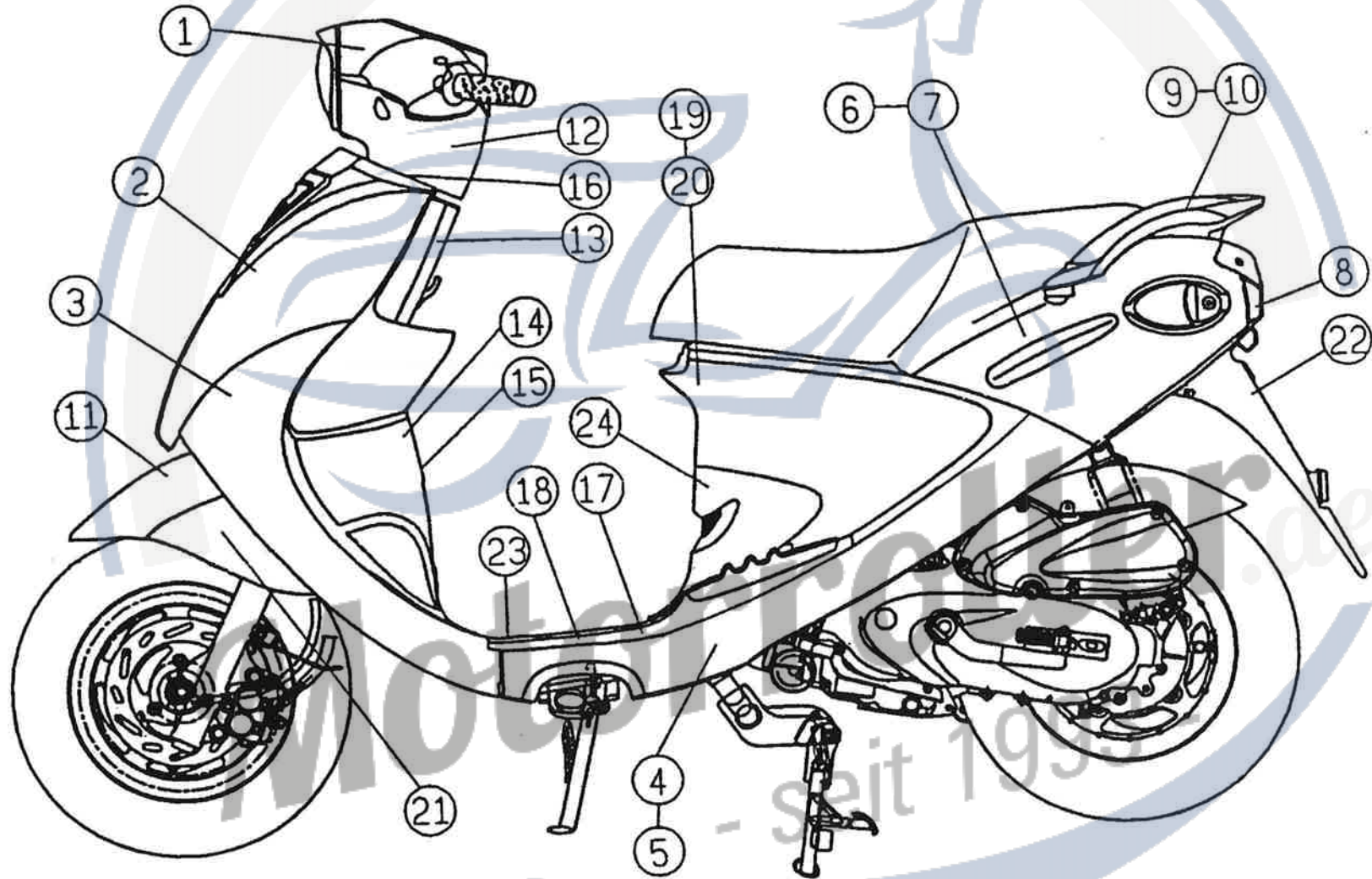

Name/Color	BLACK+SILVER (D6)
1. HANDLE UPPER COVER	P5613000690
2. WINDSHIELD	P66210026900
3. FRT LOWER COVER	P56260137J0
4. LH SIDE COVER	P66263007J0
5. RH SIDE COVER	P66265007J0
6. LH BODY COVER	P66253026900
7. RH BODY COVER	P66255026900
8. REAR COVER	P6625700690
9. RR LUGGAGE BRACET	P66760007J0
10. RR LUGGAGE COVER	P6676010000
11. FRT SECTION, FRT FENDER	P5632000690
12. HANDLE LOWER COVER	P56140026500
13. UPPER SECTION, INNER COVER	P56230316500
14. LOWER SECTION, INNER COVER	P56230416500
15. VIN COVER	P56230116500
16. FRT PANET, INNER COVER	P66250116500
17. STEPFLOOR	P6624501000
18. BATTERY COVER	C26240326500
19. BODY COVER, LH FRT	P662E010650
20. BODY COVER, RH FRT	P662E020650
21. LICENCE PLATE	P56360046500
22. MAT FLOOR	P6624501000
23. MIDDLE COVER	P66250116500

E1

曲軸箱機油泵  
CRANKCASE OIL PUMP

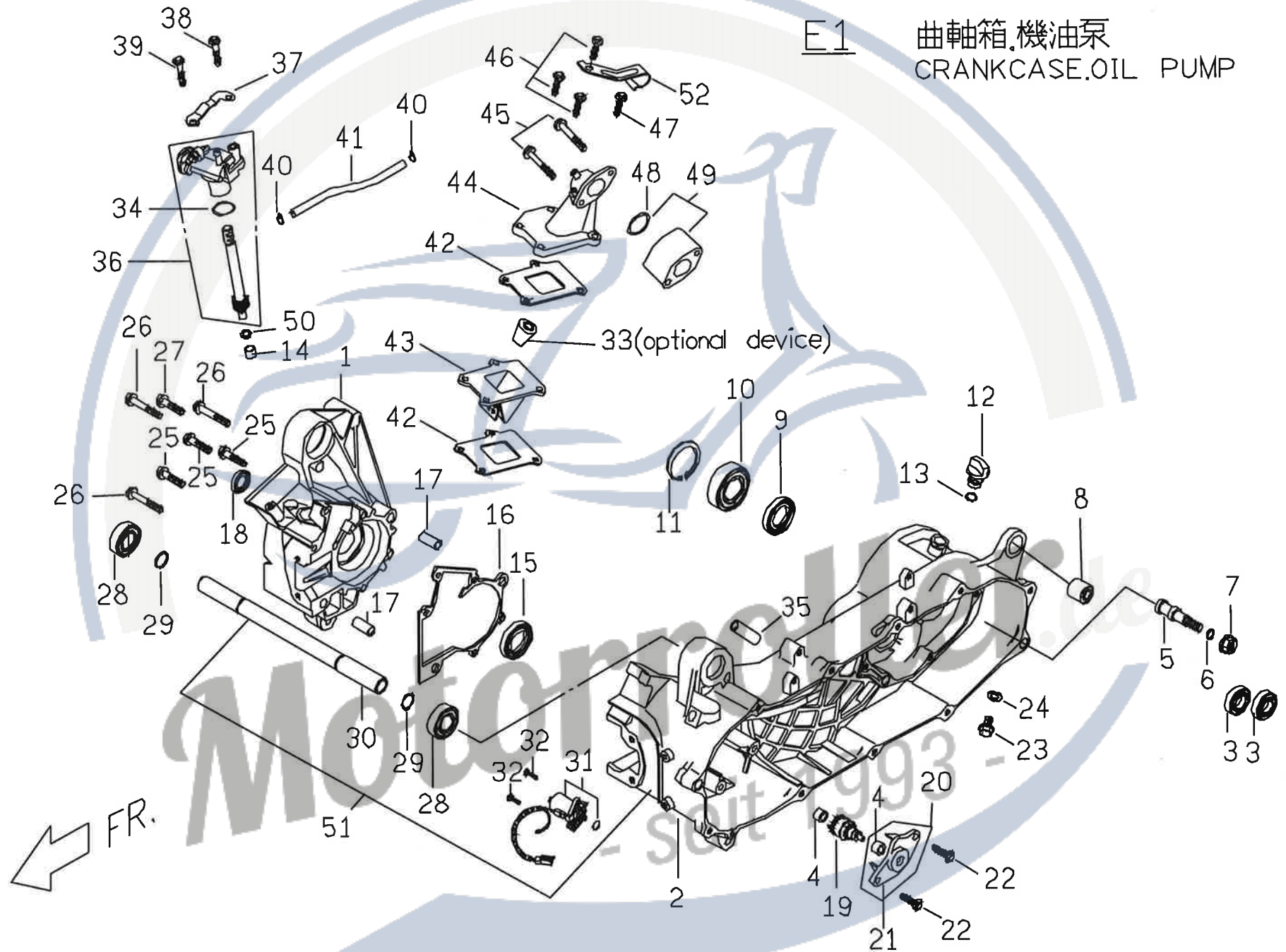



## E1 CRANKCASE

No.	Part No.	Q'TY	PART NAME	REMARK	FMSP
1	P5061010000	1	RH. CRANKCASE		
2	P5062011000	1	LH. CRANKCASE		
3	96510620000	2	BALL BEARING		
4	E1062130000	2	BUSH	NOT SUPPLIED	
5	P1407431000	1	PIVOT,RR. BRAKE SHOE		
6	95510800000	1	O RING		
7	92060800000	1	HEXAGON FLANGE NUT		
8	P1062020000	1	RUBBER BUSH		
9	95572540700	1	OIL SEAL TC TYPE		
10	96530620400	1	BALL BEARING DOUBLE SEALED		
11	92164700000	1	RETAINING RING C TYPE		
12	P1062150000	1	OIL BOLT		
13	95511400000	1	O RING		
14	E1061030000	1	OIL PUMP BUSH		
15	95572038700	1	OIL SEAL TC TYPE		Y
16	P1061041000	1	CRANKCASE GASKET		Y
17	93541002300	2	LOCK PIN		
18	95571525700	1	OIL SEAL TC TYPE		Y
19	E1242000000	1	IDLE GEAR COMP., STARTER		Y
20	P1242111000	1	FIXED PLATE STARTER COMP.		Y
21	NA	1	FIXING PLATE	NOT SUPPLIED	
22	90180602000	2	HEXAGON FLANGE BOLT		
23	90190801200	1	HEXAGON FLANGE BOLT		
24	92140800001	1	WASHER		
25	90190604500	3	HEXAGON FLANGE BOLT		
26	90190606000	3	HEXAGON FLANGE BOLT		
27	90190602700	1	HEXAGON FLANGE BOLT		

**E1 CRANKCASE**

No.	Part No.	Q'TY	PART NAME	REMARK	FMSP
28	96530600301	2	BALL BEARING DOUBLE SEALED		
29	92171700000	2	RETAINING RING C TYPE		
30	C1486020000	1	ENGINE HANGER SHAFT		
31	E1241001000	1	MOTOR COMP., STARTER		Y
32	90210602000	2	HEXAGON FLANGE BOLT		
33	P52610500001	1	RESTRICTED PLATE(9.5mm)		
34	95512000001	1	O RING		
36	P10810010001	1	OIL PUMP ASSY.		Y
37	P10812100000	1	OIL PUMP PLATE		
38	90190603500	1	HEXAGON FLANGE BOLT		
39	90190601203	1	HEXAGON FLANGE BOLT		
40	93550500800	2	SPRING PIN		
41	P50813020000	1	RUBBER TUBE		Y
42	P1261021000	2	GASKET, REED VALVE		Y
43	P1261101000	1	REED VALVE COMP.		Y
44	P5261011000	1	INTAKE MANIFOLD		
45	90190604500	2	HEXAGON FLANGE BOLT		
46	90180602500	4	HEXAGON FLANGE BOLT		
47	P0286330000	1	AIR PIPE	FOR SAI	
48	95512300000	1	O RING		
49	P5261300000	1	INSULATOR, ASSY., CARB.		
50	92140700001	1	PLAIN WASHER		
51	P506K010000	1	R/L CRANKCASE COMP.	W/O SAI	
52	P1706400000	1	FIXING CLIP		

Motorroller.de  
- seit 1993 -

E2. FAN COVER.COOLING COWL  
CYLINDER,CYLINDER HEAD

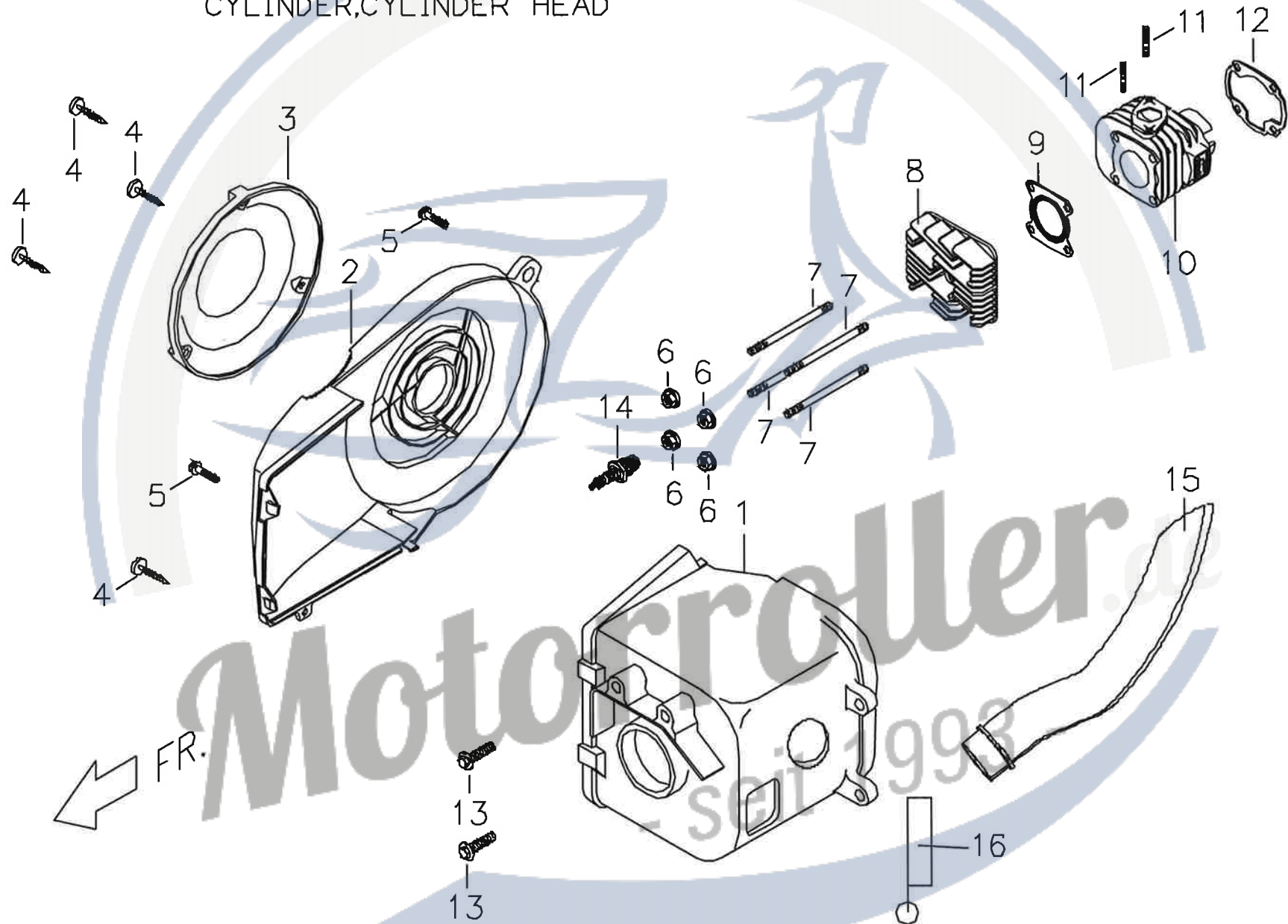

**E2 CYLINDER**

No.	Part No.	Q'TY	PART NAME	REMARK	FMSP
1	P1042102000	1	COOLING COWL	W/O AIR PIPE(EURO)	Y
2	P1042001000	1	FAN COVER		Y
3	E1042200000	1	FAN COVER		Y
4	90110401200	4	CR PAN HD. TAPPING SCREW		
5	90180602000	2	HEXAGON FLANGE BOLT		
6	92040700000	4	HEXAGON FLANGE NUT		
7	P1061050000	4	STUD BOLT		
8	P1065010000	1	CYLINDER HEAD		Y
9	P1065110000	1	GASKET, CYLINDER HEAD		Y
10	P1064010000	1	CYLINDER		
11	90170602901	2	STUD BOLT		
12	P1064111000	1	CYLINDER GASKET		Y
13	90190601203	2	HEXAGON FLANGE BOLT		
14	P12220000002	1	IGNITION PLUG		Y
15	NA	1	AIR PIPE	FOR FROZEN AREA	
16	P5706040000	1	RR BRAKE TAKER		Y

**Motorroller.de**  
- seit 1993 -



E3 風扇.發電機  
FAN,GENERATOR

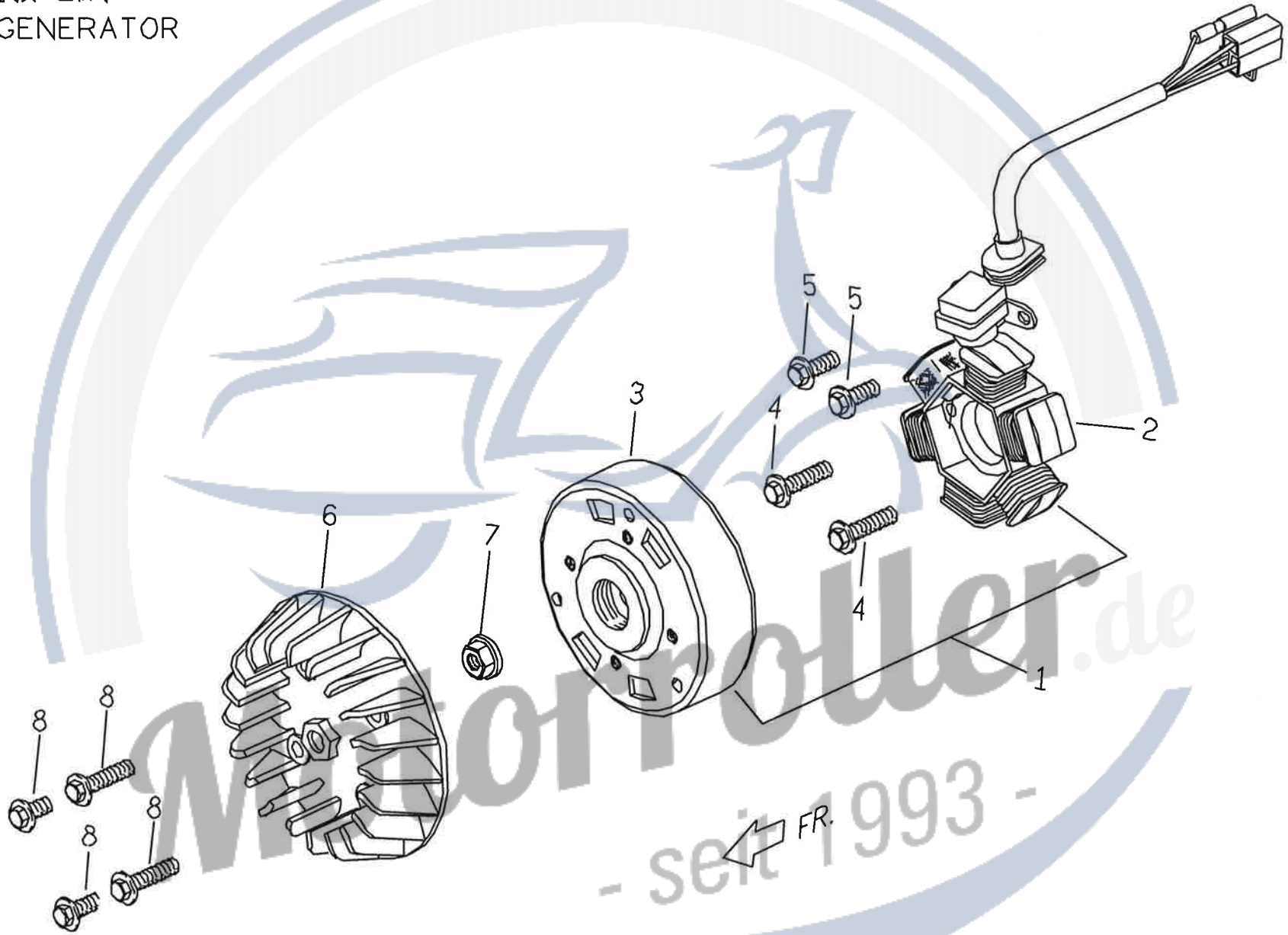



## E3 GENERATOR

No.	Part No.	Q'TY	PART NAME	REMARK	F MSP
1	P12210010003	1	AC GENERATOR ASSY.		
2	P12210210003	1	FLYWHEEL COMP.		Y
3	P1221010000	1	STATOR COMP.		
4	90180602000	2	HEXAGON FLANGE BOLT		
5	90190601203	2	HEXAGON FLANGE BOLT		
6	P1043000000	1	FAN		Y
7	92041000000	1	HEXAGON FLANGE NUT		
8	90190601204	4	HEXAGON FLANGE BOLT		

**Motorroller.de**  
- seit 1993 -

E4 DRIVING FACE

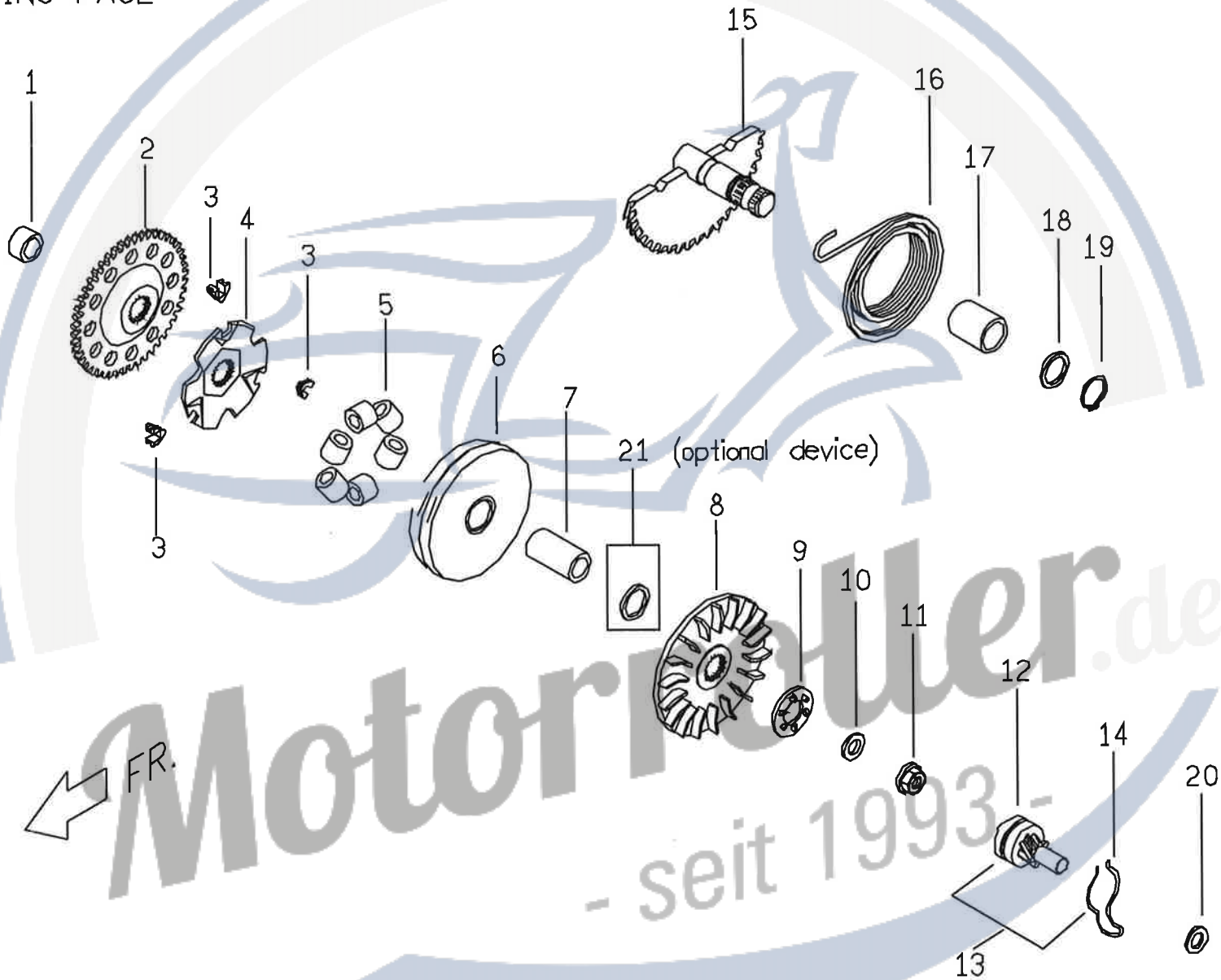

## E4 DRIVING PULLEY

No.	Part No.	Q'TY	PART NAME	REMARK	FMSP
1	P5242210000	1	SPACER		
2	P1242200000	1	DRIVEN GEAR, STARTER		Y
3	P1121320000	3	SLIDE PIECE		Y
4	P1121310000	1	RAMP PLATE		Y
5	P11212000001	6	WEIGHT ROLLER COMP. (7.5G)		Y
6	P1121101000	1	DRIVING FACE COMP., MOVABLE		Y
7	P5121050000	1	BOSS, MOVABLE DRIVE FACE		Y
8	P1121060000	1	DRIVE FACE		Y
9	P1251030000	1	RATCHET KICK STARTER		Y
10	92141000001	1	PLAIN WASHER		
11	92041000001	1	HEXAGON FLANGE NUT		
12	NA	1	DRIVEN GEAR COMP., KICK STARTER	NOT SUPPLIED	
13	E1251000000	1	DRIVEN GEAR & SPRING COMP.		Y
14	NA	1	SPRING, FRICTION STARTER GEAR	NOT SUPPLIED	
15	E1251101000	1	SPINDLE COMP., KICK STARTER		Y
16	E2251110000	1	TORSION SPRING		
17	E1251120000	1	BUSH		
18	92141400000	1	PLAIN WASHER		
19	92171400000	1	RETAINING RING C TYPE		
20	92141000011	1	PLAIN WASHER		
21	P11210800003	1	COLLAR (4.0mm)		

Motorroller.de  
- seit 1993 -



E5

曲柄軸, 活塞  
CRANKSHAFT, PISTON

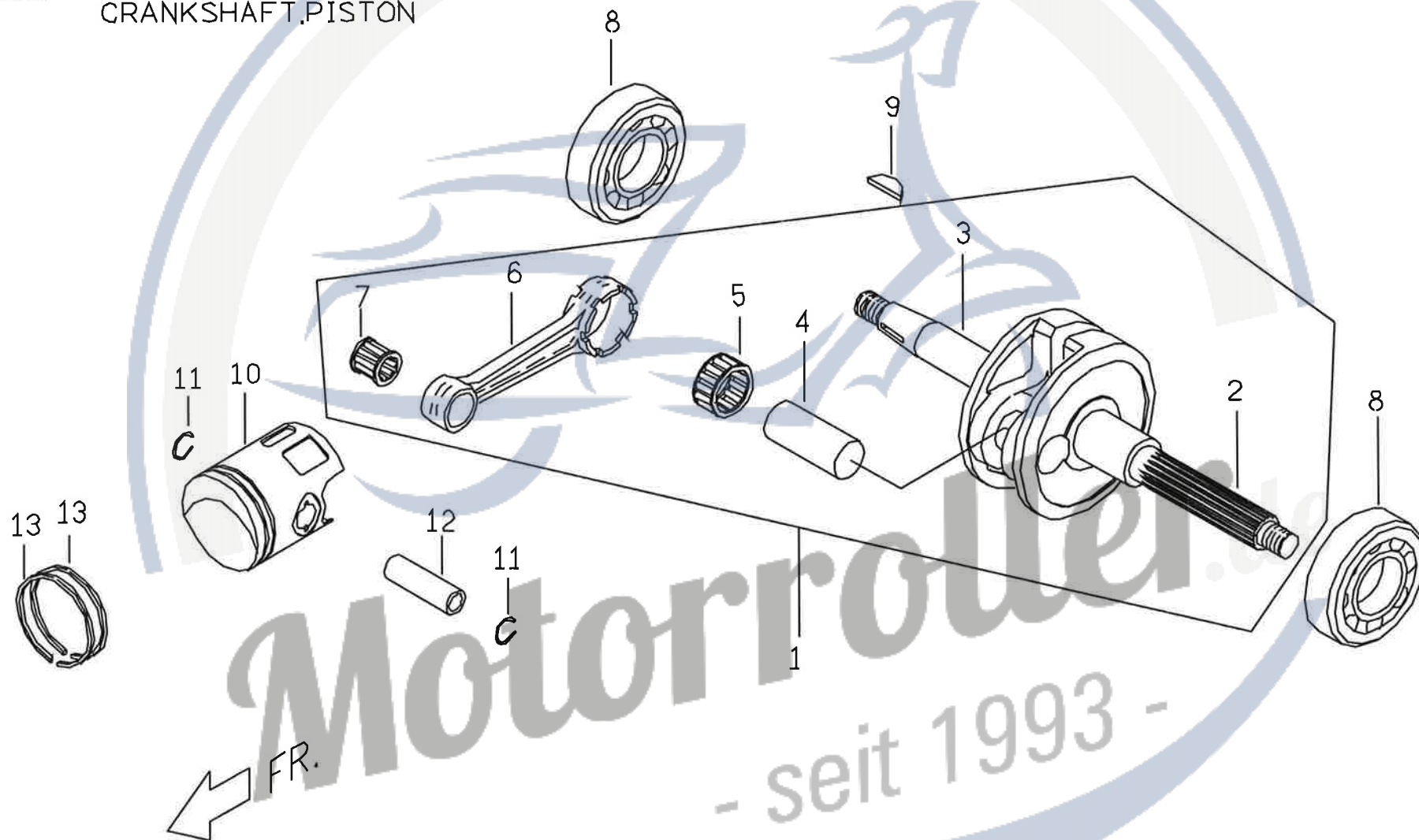

**E5 CRANKSHAFT**

No.	Part No.	Q'TY	PART NAME	REMARK	FMSP
1	P1066000000	1	CRANKSHAFT COMP.		
2	NA	1	LH., CRANKSHAFT	NOT SUPPLIED	
3	NA	1	RH., CRANKSHAFT	NOT SUPPLIED	
4	P1066030000	1	CRANK PIN		
5	96590162200	1	BEARING CAGE		
6	P1066120000	1	CONNECTING ROD		
7	96601001400	1	BEARING CAGE		
8	E1062100000	2	BALL BEARING		
9	93530302400	1	WOODEUFF KEY		
10	P1067010000	1	PISTON		Y
11	E1067150000	2	CLIP, PISTON PIN		Y
12	P1067110000	1	PISTON PIN		Y
13	E10673100001	2	PISTON RING		Y

**Motorroller.de**  
- seit 1993 -

E6 被驅動面皮帶輪組合  
BELT PULLEY COMP., DRIVEN FACE

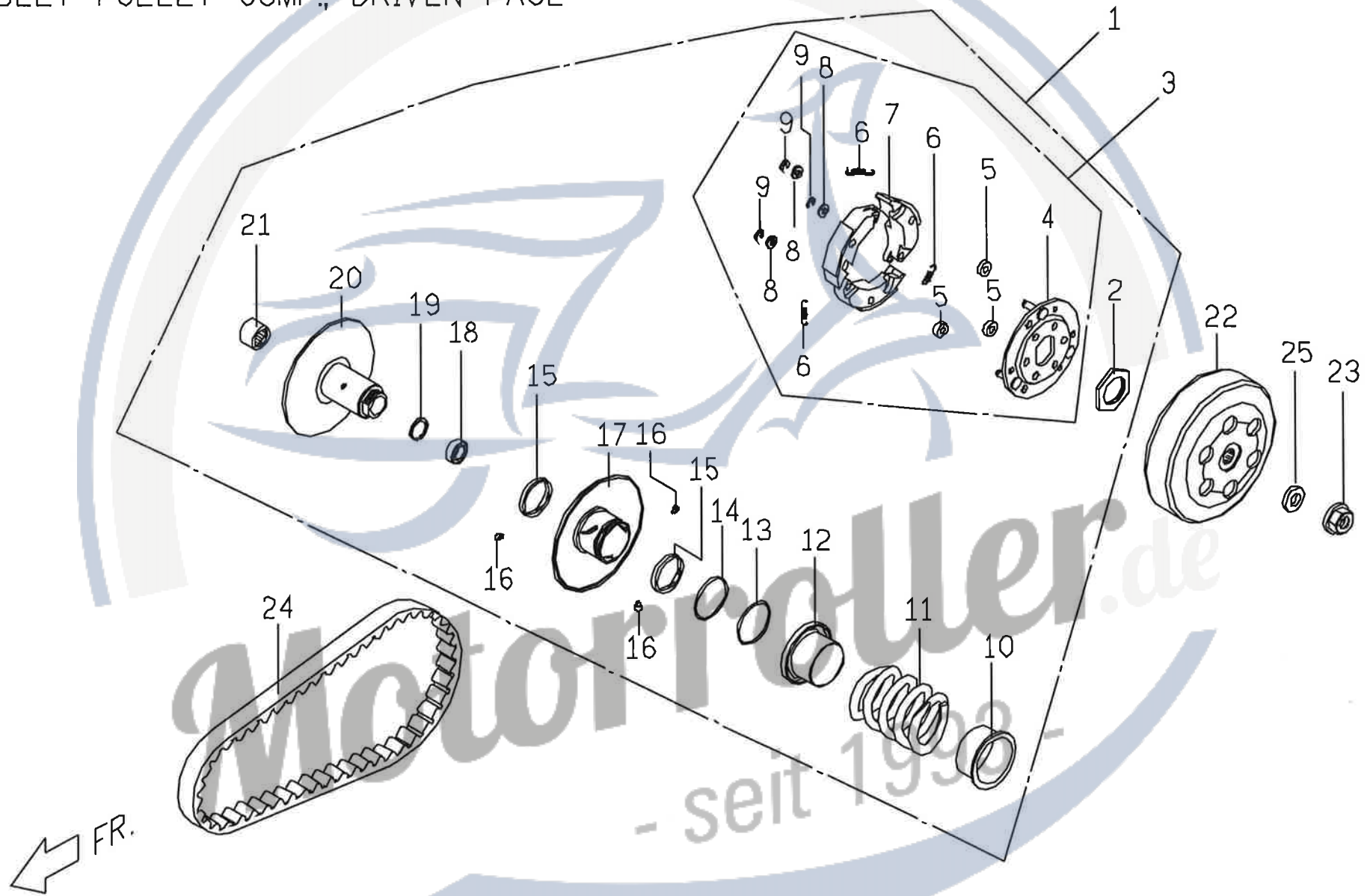



## E6 DRIVEN PULLEY

No.	Part No.	Q'TY	PART NAME	REMARK	FMSP
1	P11237000009	1	BELT PULLEY COMP., DRIVEN FACE	EURO	Y
2	P1123410000	1	NUT		
3	P1123601000	1	DRIVE PLATE COMP	EURO	Y
4	P1123300000	1	BODY COMP., DRIVE PLATE		
5	P1123420000	3	DAMPER RUBBER, CLUTCH		
6	P1123430000	3	SPRING, CLUTCH	EURO	
7	P1123441000	3	WEIGHT SET, CLUTCH		
8	92140600008	3	PLAIN WASHER		
9	92180500000	3	RETAINING RING E TYPE		
10	P1123330000	1	COLLAR SPRING		
11	P1123520000	1	SPRING, DRIVEN FACE		
12	P1123530000	1	SEALED SOCKET		
13	95513600000	1	O RING		
14	95514000001	1	O RING		
15	95593439300	2	OIL SEAL G TYPE		
16	P1123240000	3	PIN, GUIDE ROLLER		
17	P1123210000	1	BODT COMP., MOVABLE DRIVEN FACE		
18	96520690100	1	DEEP GROOVE BALL BEAR ONE SEAL		
19	92162400000	1	RETAINING RING C TYPE		
20	P1123110000	1	BODY COMP., DRIVEN FACE		
21	E1123140000	1	NEEDLE BEARING		
22	P1123510000	1	OUTER BODY COMP., CLUTCH		Y
23	92041000000	1	HEXAGON FLANGE NUT		Y
24	P1122000000	1	BELT		Y
25	92141000001	1	PLAIN WASHER		

E7 左邊蓋  
LH, SIDE COVER

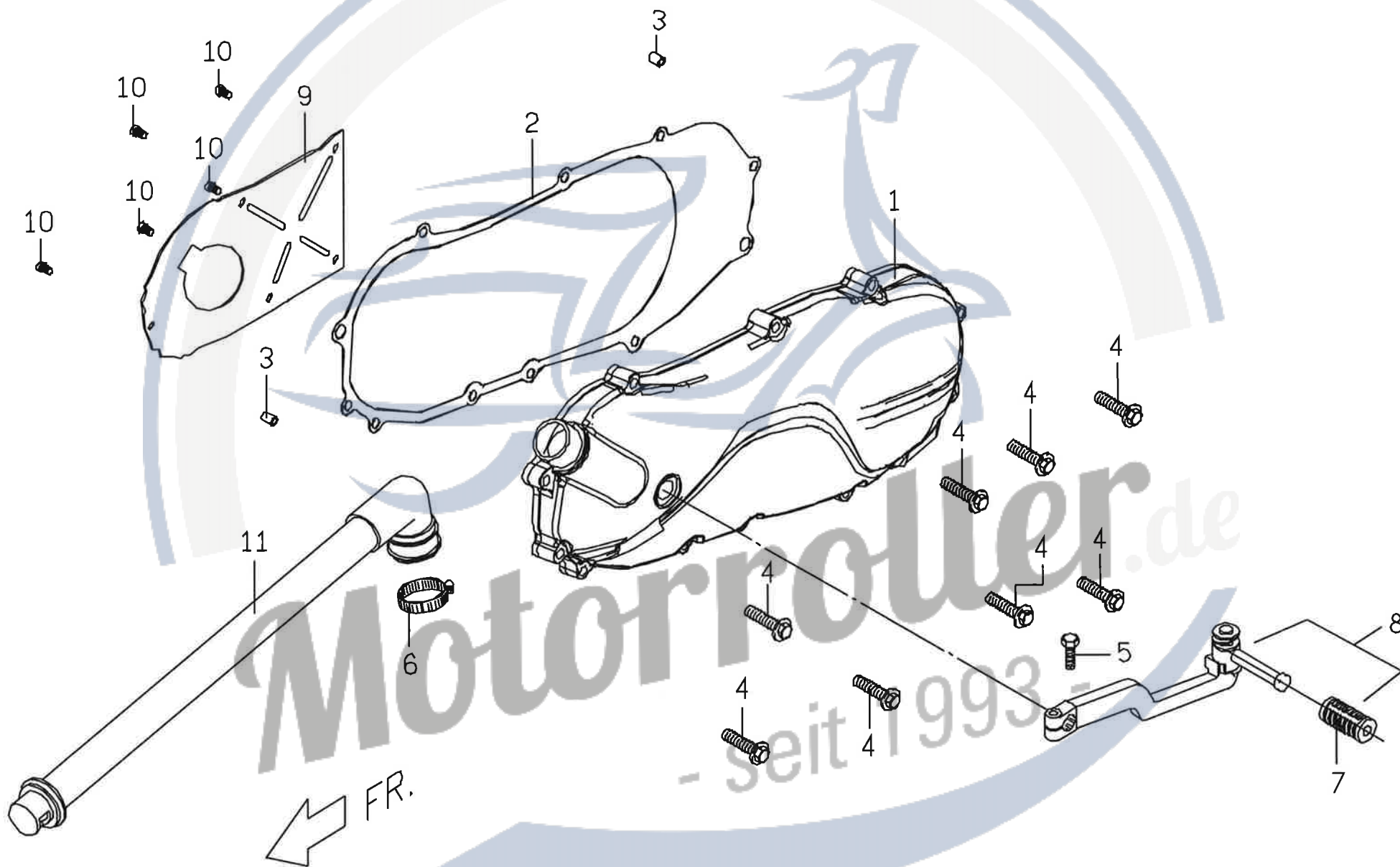

**E7 LEFT CASE****AVAILABLE FOR PA-50**

No.	Part No.	Q'TY	PART NAME	REMARK	FMSP
1	P5063010720	1	LH., SIDE COVER	SILVER	Y
2	P5063021000	1	GASKET, LH. SIDE COVER		Y
3	93541001401	2	LOCK PIN		
4	90190603502	8	HEXAGON FLANGE BOLT		
5	90020602202	1	HEXAGON HEAD BOLT		
6	E1706280000	1	HOSE CLAMP		
7	E1251240000	1	RUBBER PAD, KICK STARTER		
8	P1251200000	1	ARM COMP., KICK STARTER		Y
9	P1063060000	1	PARTITION PLATE		
10	90050500900	5	CR ROUND HD. MACHINE SCREW		
11	P5063030000	1	BREATHER PIPE		Y

**Motorroller.de**  
- seit 1993 -



E8 傳動系  
TRANSMISSION

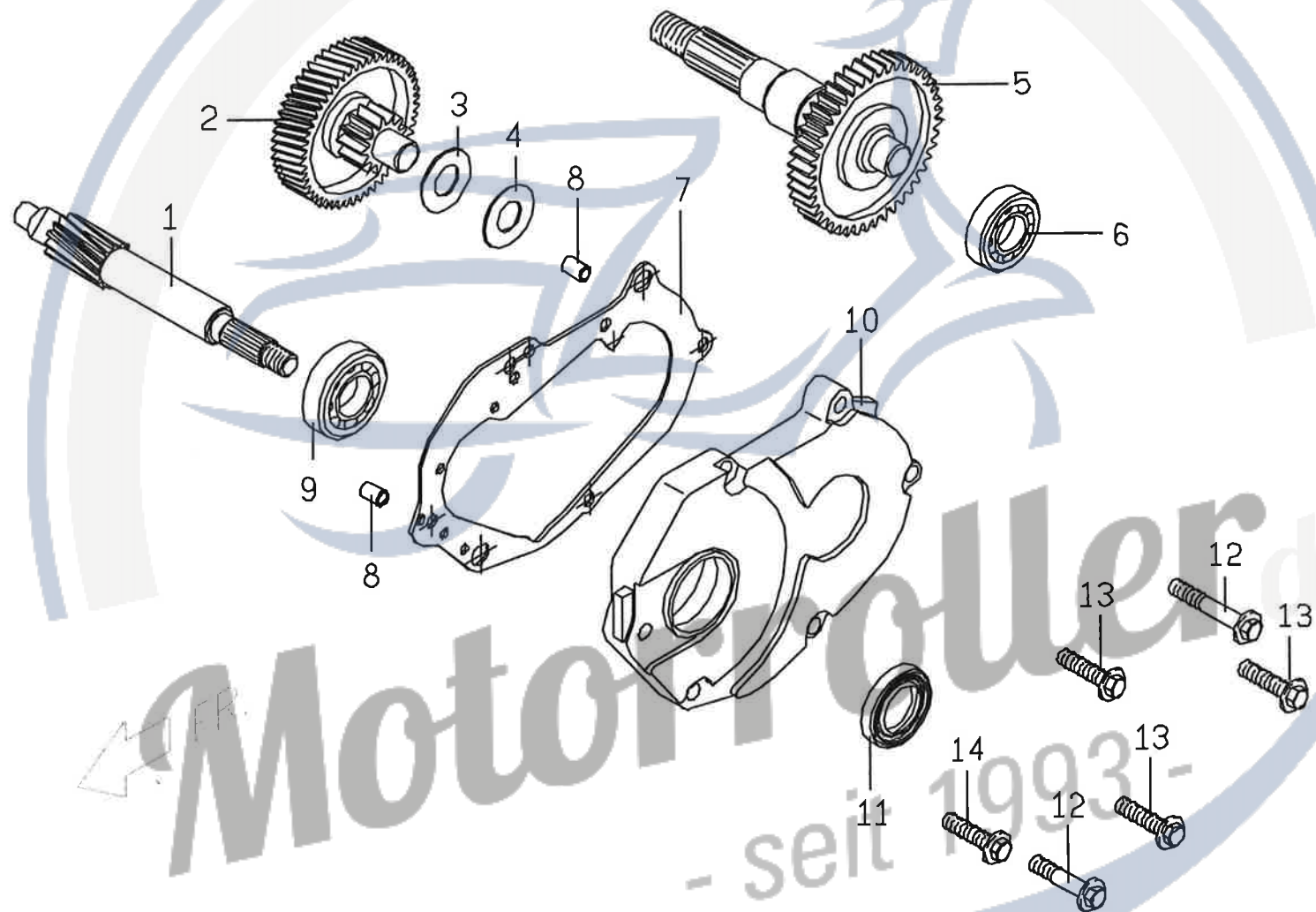

**E8 TRANSMISSION**

No.	Part No.	Q'TY	PART NAME	REMARK	FMSP
1	P5141100000	1	DRIVE SHAFT		
2	P5141200000	1	IDLE GEAR COMP.		
3	P1141230000	1	DISC SPRING WASHER		
4	92141400003	1	PLAIN WASHER		
5	P5141300000	1	FINAL GEAR COMP.		Y
6	96510620200	1	BALL BEARING		
7	P1141021000	1	TRANSMISSION COVER GASKET		Y
8	93541001401	2	LOCK PIN		
9	96510620301	1	BALL BEARING		
10	P1141010000	1	TRANSMISSION COVER		Y
11	95571735700	1	OIL SEAL TC TYPE		Y
12	90190603500	2	HEXAGON FLANGE BOLT		
13	90180602500	3	HEXAGON FLANGE BOLT		
14	90180602000	1	HEXAGON FLANGE BOLT		

**Motorroller.de**  
- seit 1993 -

E9.2 化油器  
CARBURETOR

FR.

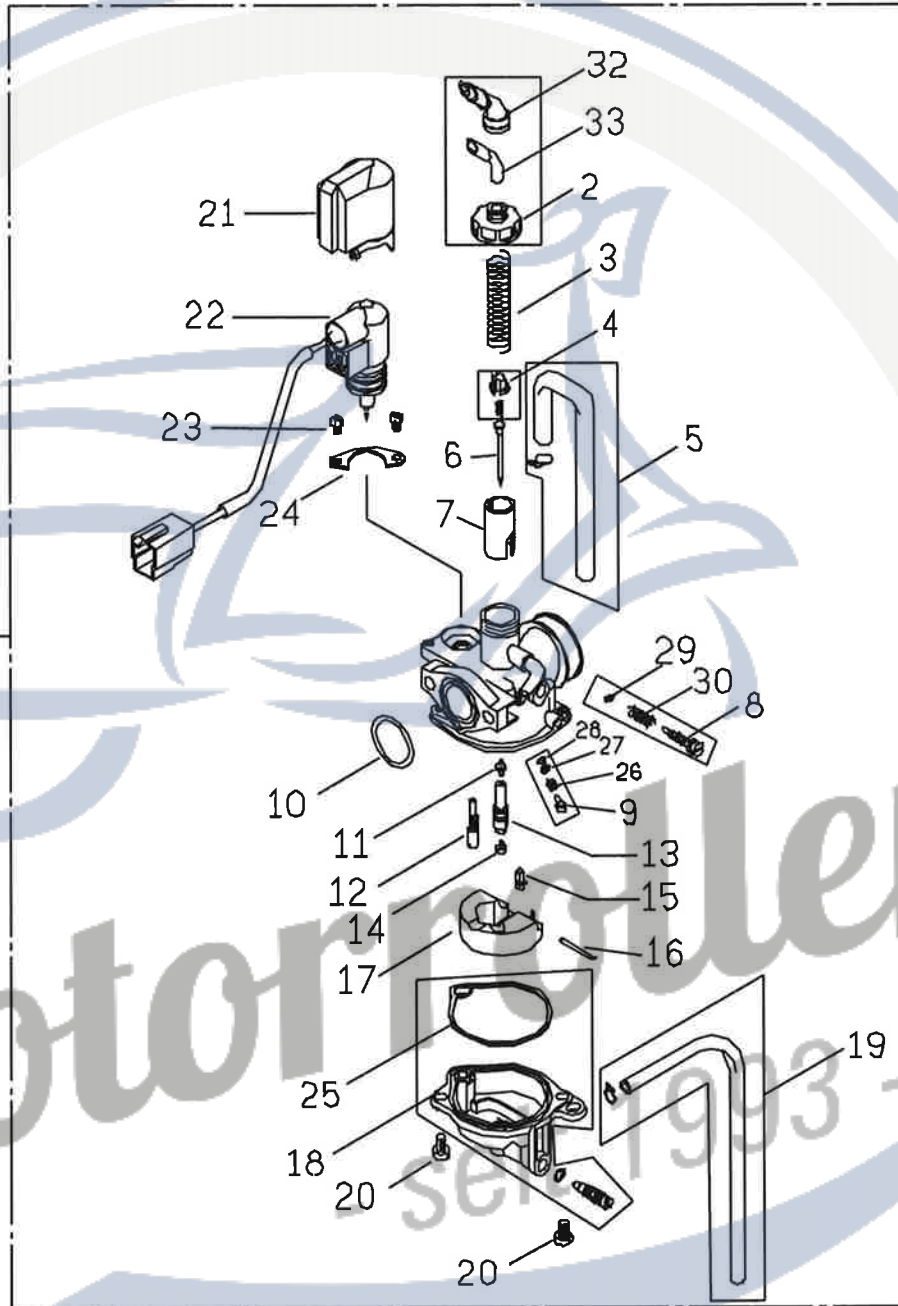

**E9.2 CARBURETOR**

AVAILABLE FOR SPEED LIMIT MODEL

No.	Part No.	Q'TY	PART NAME	REMARK	FMSP
1	P5151000005	1	CARBURETOR ASSY.	EURO	Y
2	D1590TA10100	1	TOP SET		
3	1300KG8H9000	1	SPG., COMP.		
4	1019GW3H9800	1	PLATE SET		
5	16199GY69000	1	TUBE SET		
6	D1425F010100	1	JET NEEDLE		
7	1020GWOH9200	1	THROTTLE VALVE		
8	D15358580100	1	SCREW ( S.S )		
9	1014252H9900	1	SCREW ( A.S )		
10	16076KG89010M1	1	O RING		
11	1010GW2H9000	1	NEEDLE JET		
12	1001GZOH0351	1	SLOW JET		
13	N41332A00	1	HOLDER, NEEDLE JET		
14	991011160500	1	JET, MAIN	EURO	
15	106BKG8H9801	1	FLOAT VALVE SET		
16	16152KG89010M1	1	PIN, ARM		
17	105B073H9931	1	FLOAT SET		
18	N35031K00	1	FLOAT CHAMBER SET		
19	16147MN90040	1	TUBE SET		
20	938920401418	2	SCREW, WASHER		

**Motorroller.de**  
- seit 1993 -



## E9.2 CARBURETOR

No.	Part No.	Q'TY	PART NAME	REMARK	FMSP
21	D17838380100	1	CAP HOLDER		
22	40000440000	1	AUTO BYSTARTER SET		Y
23	938920400818	2	SCREW, WASHER		
24	1703GJ2H0040	1	PLATE SET		
25	1051KG8H9010	1	FLOAT CHAMBER GASKET		
26	1300KG8H9010	1	COMPRESSION SPRING,AS		
27	1795KG8H9010	1	PLAIN WASHER, AS		
28	16075KG89010M1	1	O-RING, AS		
29	16076ND50040	1	O-RING, SS		
30	1300KG8HQ010	1	COMPRESSION SPRING, SS		
31	1300GW3HQ800	1	COMPRESSION SPRING, PLATE SET		
32	1028GB4H0030	1	CABLE SEALING CAP		
33	1031KG8HQ010	1	TOP GASKET		

**Motorroller.de**  
- seit 1993 -

E10 空氣濾清器組合  
AIR CLEANER COMP.

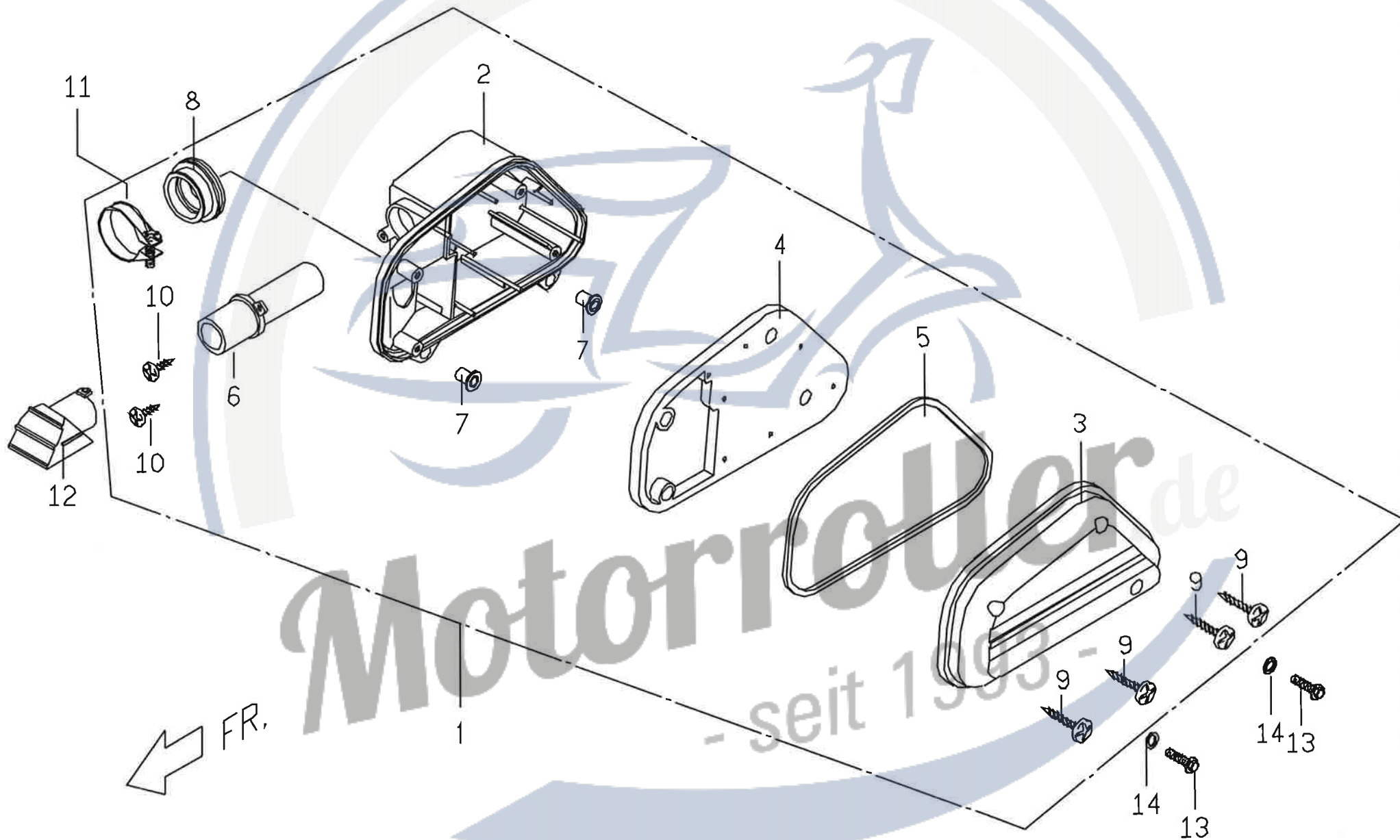

**E10 AIR CLEANER**

No.	Part No.	Q'TY	PART NAME	REMARK	FMSP
1	P12620000004	1	AIR CLEANER COMP.	EURO	Y
2	P1262010000	1	BODY, AIR CLEANER	NOT SUPPLIED	
3	P1262020000	1	COVER, AIR CLEANER		
4	P1262030000	1	SPONGE, AIR CLEANER		Y
5	P1262040000	1	PACKING, AIR CLEANER		
6	P12620500002	1	AIR HOSE	EURO	
7	E9262060000	2	BUSH		
8	P1262080000	1	CONNECTION PIPE, AIR CLEANER	NOT SUPPLIED	
9	90110502500	4	CR RECESS PAN HD. TAPPING		
10	90110401200	2	CR RECESS PAN HD. TAPPING		
11	P1262110000	1	CLAMP		
12	P1262120000	1	INTAKE COVER		Y
13	90180602500	2	HEXAGON FLANGE BOLT		
14	92140600005	2	PLAIN WASHER		

**Motorroller.de**  
- seit 1993 -

E11 MUFFLER

CRANKCASE  
左曲軸箱

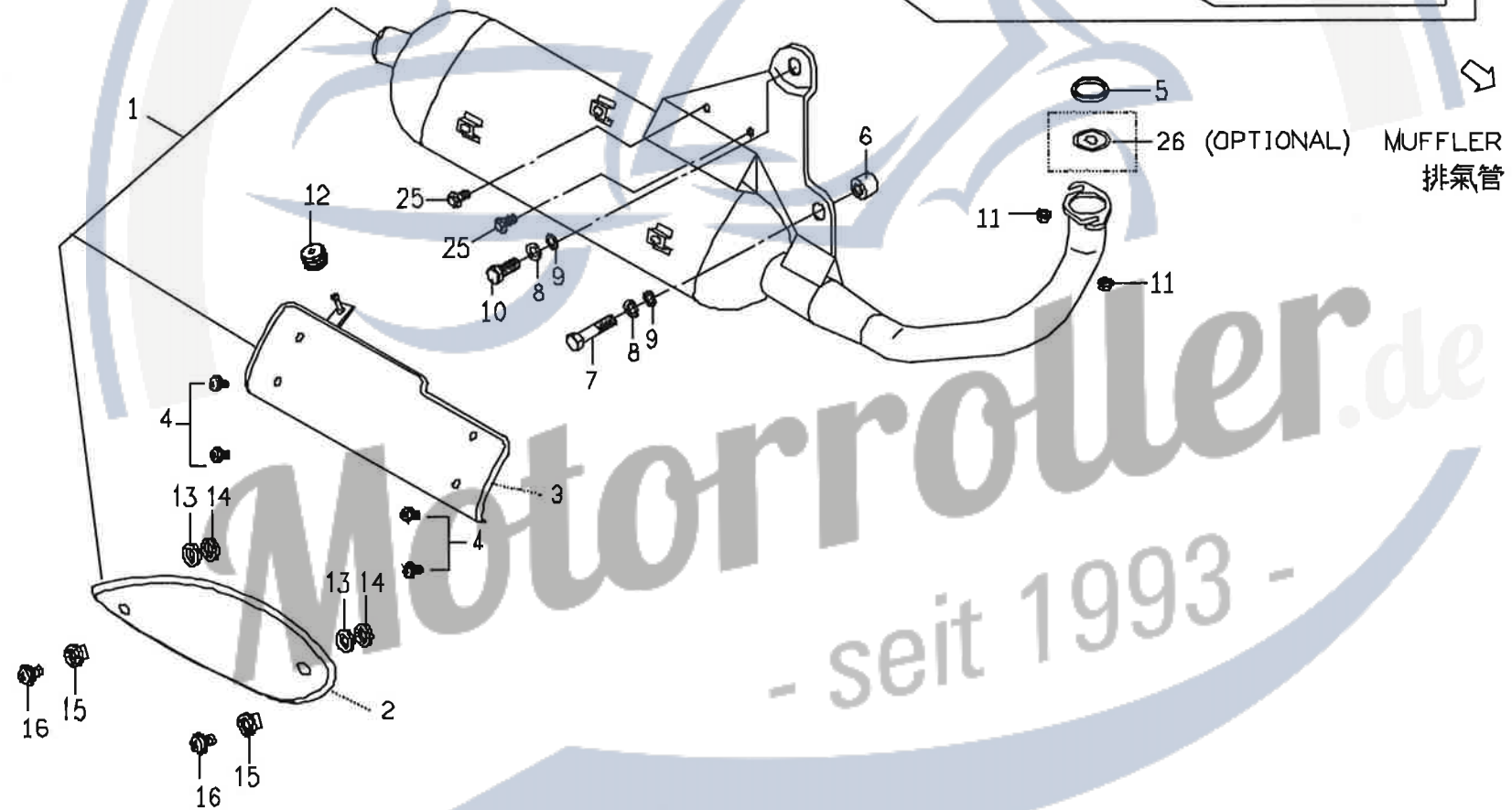
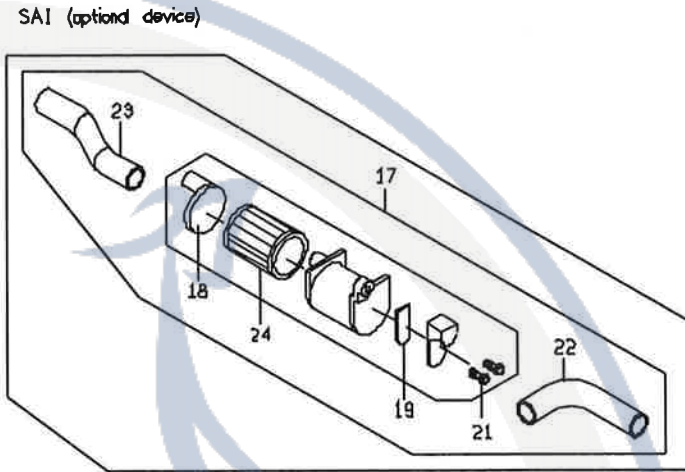

Motorroller.de  
- seit 1993 -



**E11 MUFFLER**

No.	Part No.	Q'TY	PART NAME	REMARK	FMSP
1	P5281002000B	1	MUFFLER ASSY.		Y
2	C32810100001	1	OUTSIDE HEAT PROTECTOR ASSY		Y
3	P5281020000	1	INSIDE HEAT PROTECTOR ASSY		
4	90050608000	4	CR RECESS PAN HD. TAPPING		
5	E9281020000	1	GASKET, MUFFLER		Y
6	E1062020000	1	DAMPER BUSH		
7	90190804003	1	HEXAGON BOLT		
8	92110800000	2	SPRING WASHER		
9	92140800000	2	PLAIN WASHER		
10	90190802600	1	HEXAGON BOLT		
11	92050600003	2	HEXAGON FLANGE NUT		
12	P5281060000	1	FIXING RUBBER		
13	C328A040000	2	CIRCLET		
14	92140600015	2	HIGH TEMPERATURE PLAIN WASHER		
15	C328A020000	2	INNER SPACER		
16	90050602000	2	C-R ROUND HD.TAPPING SCREW		
17	P22861020002	1	SECOND AIR CLEANER ASSY.	OPTIONAL	
18	P2286080000	1	COVER, SAI		
19	P22860100001	1	REED VALVE COMP		
21	90040501400	2	CR PAN HD. MACHINE SCREW		
22	P22861100004	1	AIR TUBE (A)		
23	P52861200001	1	AIR TUBE (B)		
24	P2286090000	1	2nd AIR FILTER		
25	90180602000	2	HEXAGON FLANGE BOLT		

E12 後輪  
REAR WHEEL

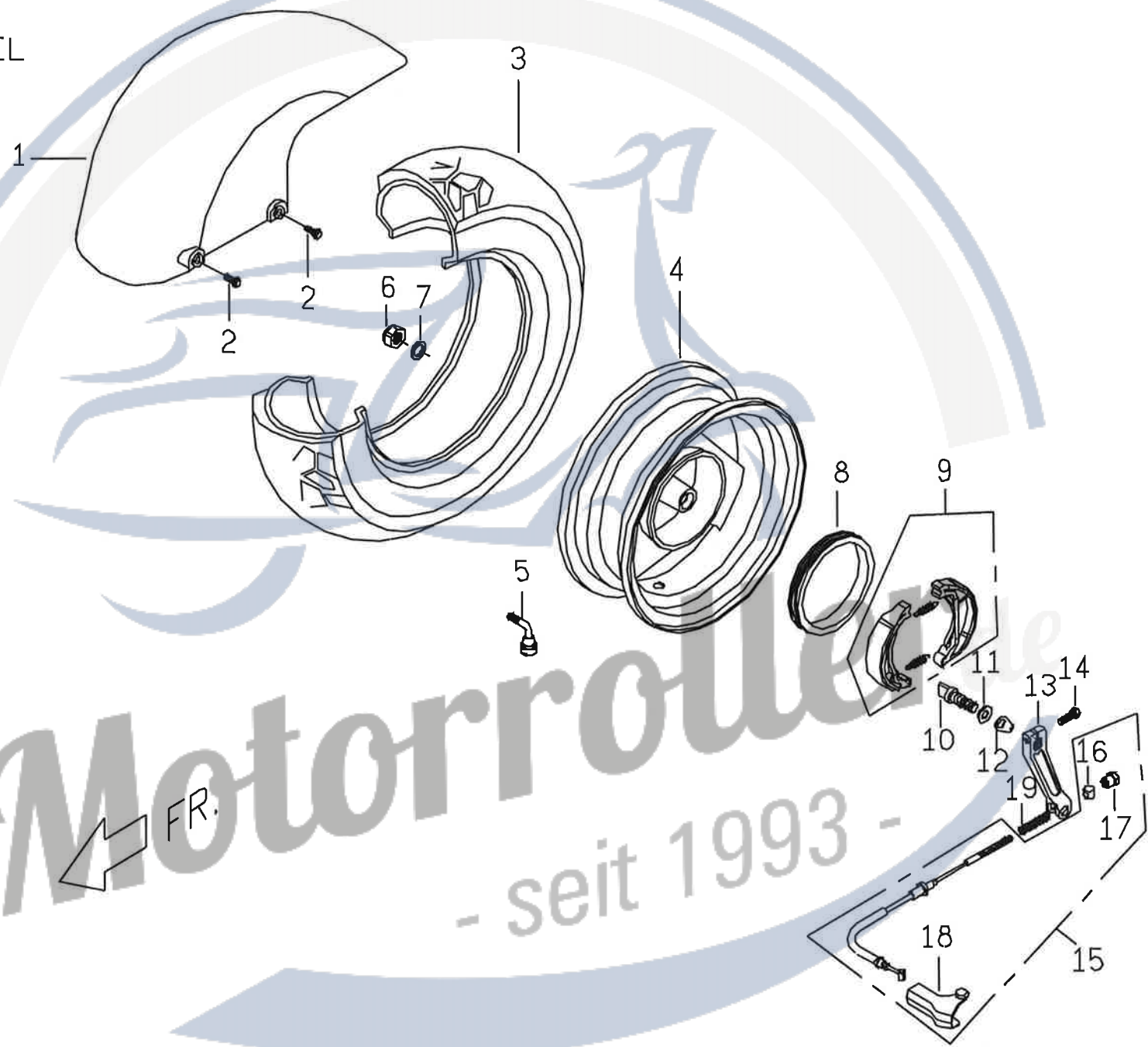

FR.

Motorroller  
- seit 1993 -

**E12 REAR WHEEL**

No.	Part No.	Q'TY	PART NAME	REMARK	FMSP
1	P56340006501	1	REAR FENDER		Y
2	90180602000	2	HEXAGON FLANGE BOLT		
3	P540B320000	1	TYRE		
4	P54071037700	1	RR WHEEL COMP.	IRON-SILVER	Y
5	P140B330000	1	VALVE		
6	92011600000	1	U TYPE NUT		
7	92141700001	1	PLAIN WASHER		
8	E1407010000	1	DUST RING	FOR IRON RIM ONLY	Y
9	E14074000002	1	BRAKE SHOE ASSY.		Y
10	E1407440000	1	CAM, RR BRAKE		
11	95511000002	1	O RING		
12	E1407450000	1	INDICATOR, RR BRAKE		
13	P1407471000	1	ARM, RR BRAKE		
14	90020602202	1	HEXAGON BOLT		
15	P65444000002	1	CABLE ASSY., RR BRAKE		Y
16	E1544440000	1	PIN		
17	E1544410000	1	ADJUST NUT, CABLE		
18	NA	1	PROTECTNG COVER		
19	C154D110000	1	SPRING, RR BRAKE ARM		

**Motorroller.de**  
- seit 1993 -

E13 STAND

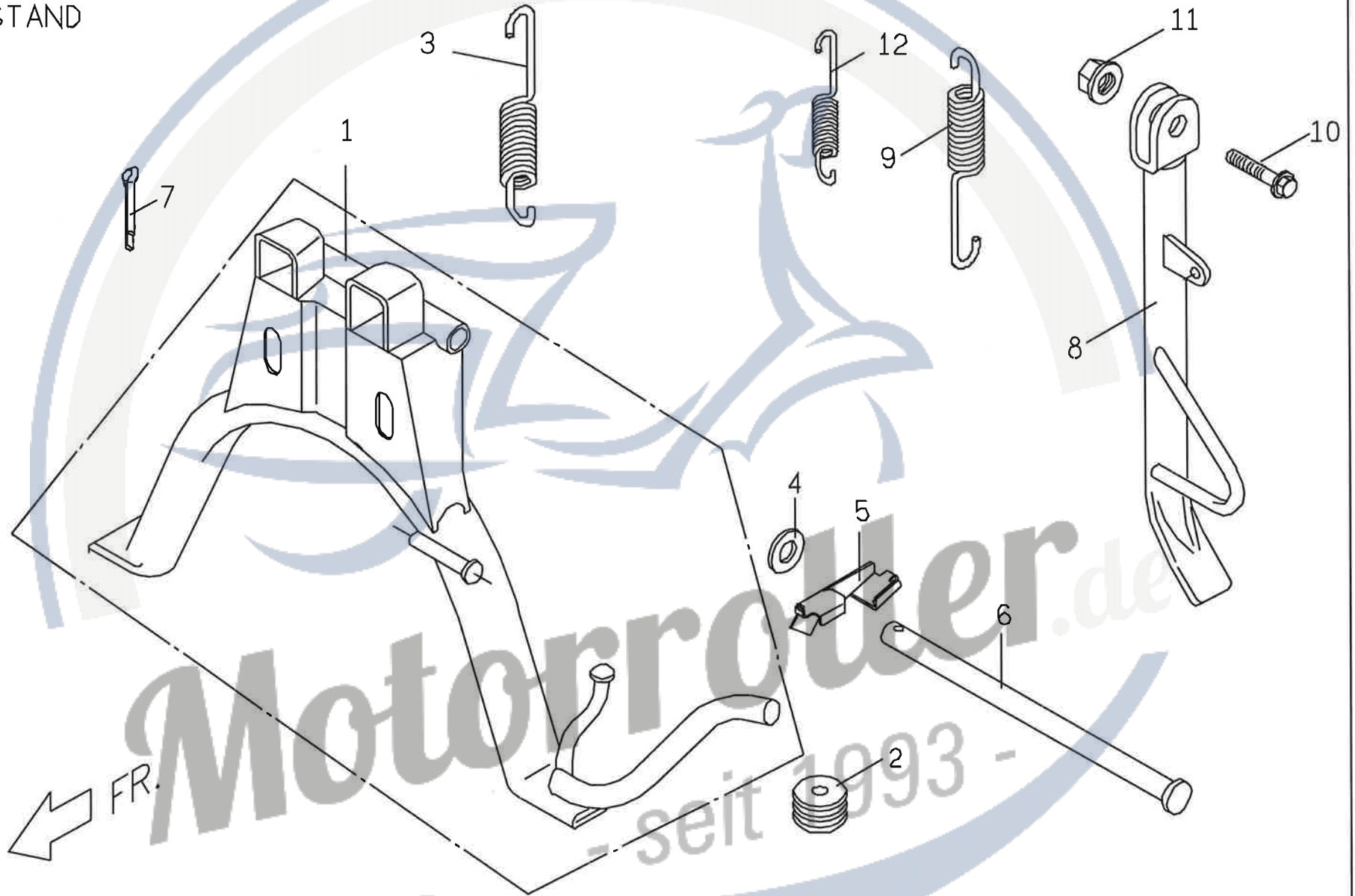



## E13 STANDS

No.	Part No.	Q'TY	PART NAME	REMARK	FMSP
1	P5461001600	1	CENTER STAND ASSY		Y
2	P146A011000	1	RUBBER DAMPING, CENTER STAND		Y
3	P1461120000	1	SPRING, CENTER STAND		Y
4	P1701070000	1	RUBBER WASHER		
5	P1407482000	1	RR BREKE FIXING PLATE		
6	E1461110000	1	CRT STD FIXING PIN		Y
7	93561010000	1	SPILT PIN		
8	P64620006001	1	SIDE SAND ASSY.		Y
9	C2462120000	2	SIDE STAND SPRING		Y
10	90020803201	1	HEXAGON FLANGE BOLT		
11	92060800000	1	U TYPE NUT		
12	P5462010000	1	SIDE STAND INNER SPRING		

**Motorroller.de**  
- seit 1993 -

F1.2 **BUBU (MOVABLE MODEL)**  
COVER UPPER & LOWER, HANDLE BAR,  
HEAD LIGHT

← FR.

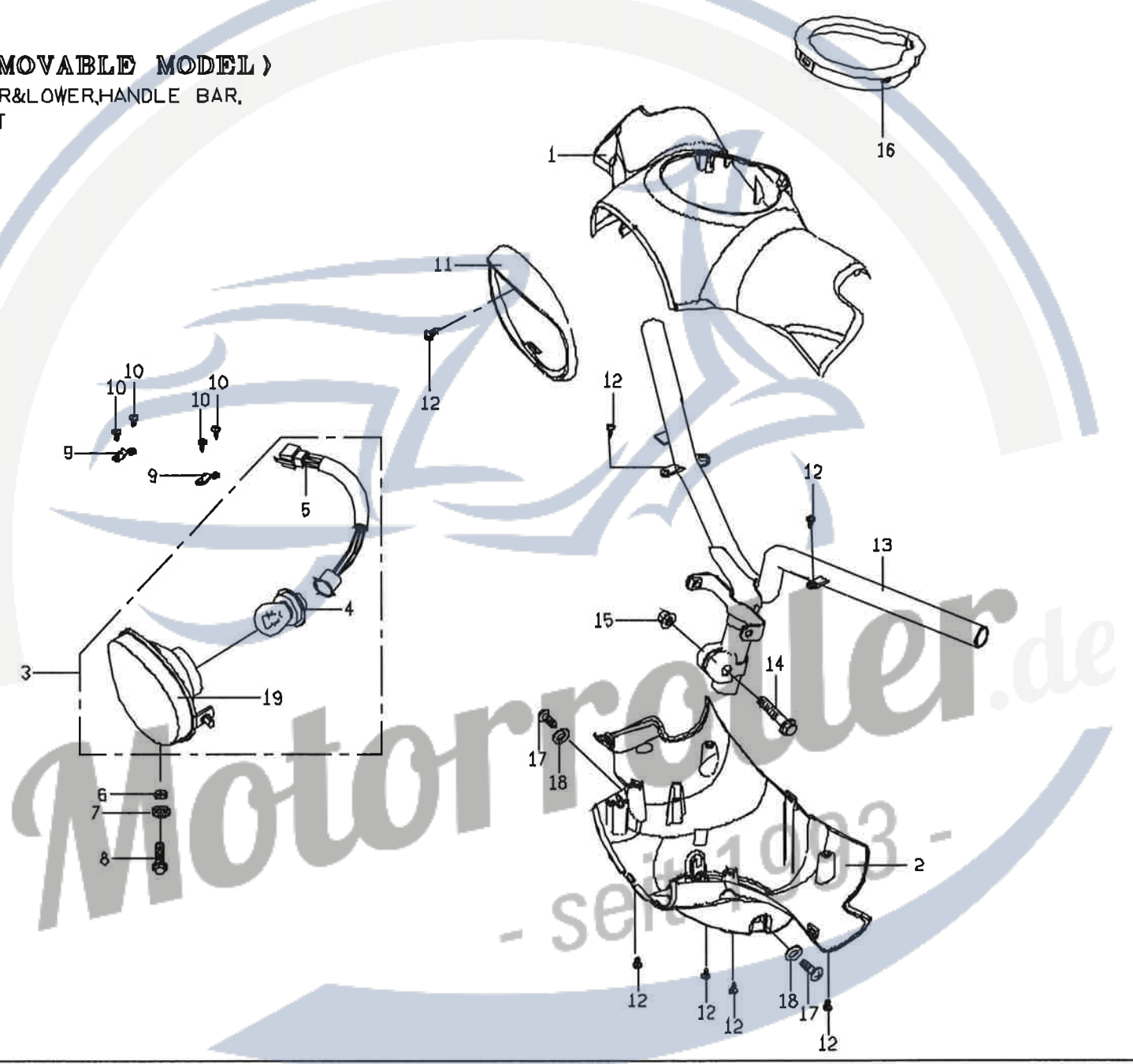



## F1.1 STEERING COVER

No.	Part No.	Q'TY	PART NAME	REMARK	FMSP
1	P56140026500	1	COVER,LOWER (black)		Y
2	P5613000690	1	COVER,UPPER		Y
3	P56610020001	1	HEADLIGHT COMP	E-mark	Y
4	98131200151	1	BULB (12V-15W)	E-MARK	E-MARK
5	P566A0400001	1	CONNECTING WIRE	E-MARK	E-MARK
6	92140500014	1	PLAIN WASHER		
7	92130600000	1	WASHER		
8	E1613010000	1	REGULATING SCREW		
9	P5706010000	2	FRONT LIGHT PLATE		
10	90130301000	4	C-R RECESS PAN HD TAPPING SCREW		
11	P5613030000	1	FR.HEAD LIGHT COVER		
12	90110401200	7	C-R RECESS PAN HD TAPPING SCREW		
13	P56120026000	1	HANDLE BAR ASSY		
14	90191004600	1	HEXAGON FLANGE BOLT		
15	92061000001	1	HEXAGON LOCK NUT		
16	P5613020000	1	SPEED METER SIDE COVER		
17	90040601400	2	C-R RECESS PAN HD TAPPING SCREW		
18	92140600000	2	PLAIN WASHER		
19	P566A0600001	1	LAMP COMP	E-MARK	E-MARK

Motorroller.de  
- seit 1993 -



F2 **BUBU**  
SPEEDOMETER

MOVABLE MODEL

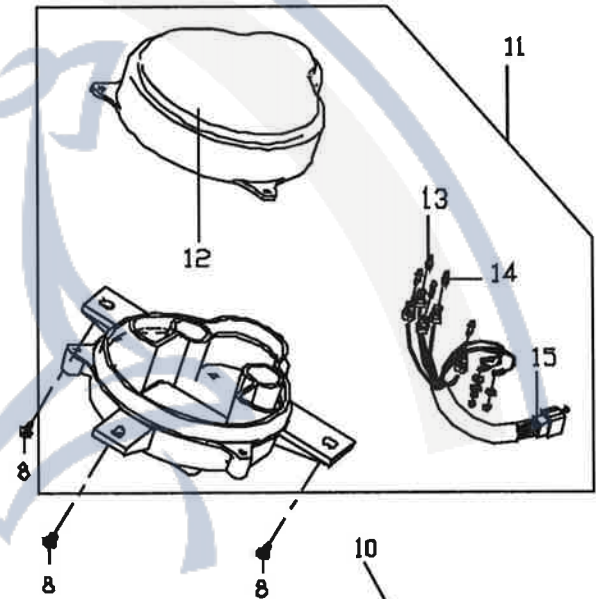

Motorroller.de  
- seit 1998 -



## F2. SPEEDOMETER

No.	Part No.	Q'TY	PART NAME	REMARK	FMSP
8	90110401200	3	C-R RECESS PAN HD TAPPING SCREW		
9	P5544003000	1	SPEEDMETER CABLE ASSY(MOVABLE )		Y
11	P55610000004	1	SPEEDMETER ASSY (MOVABLE MODEL)		Y
12	P556A010000	1	COVER UPPER (MOVABLE MODEL)		
13	P556A020000	5	BULB		
14	P556A030000	1	BULB		
15	P556A040000	1	CONNECTING WIRE (MOVABLE MODEL)		

**Motorroller.de**  
- seit 1993 -

F3 導線、開關、後視鏡 ( 撥式 )  
CABLE, SWITCH, BACK MIRROR

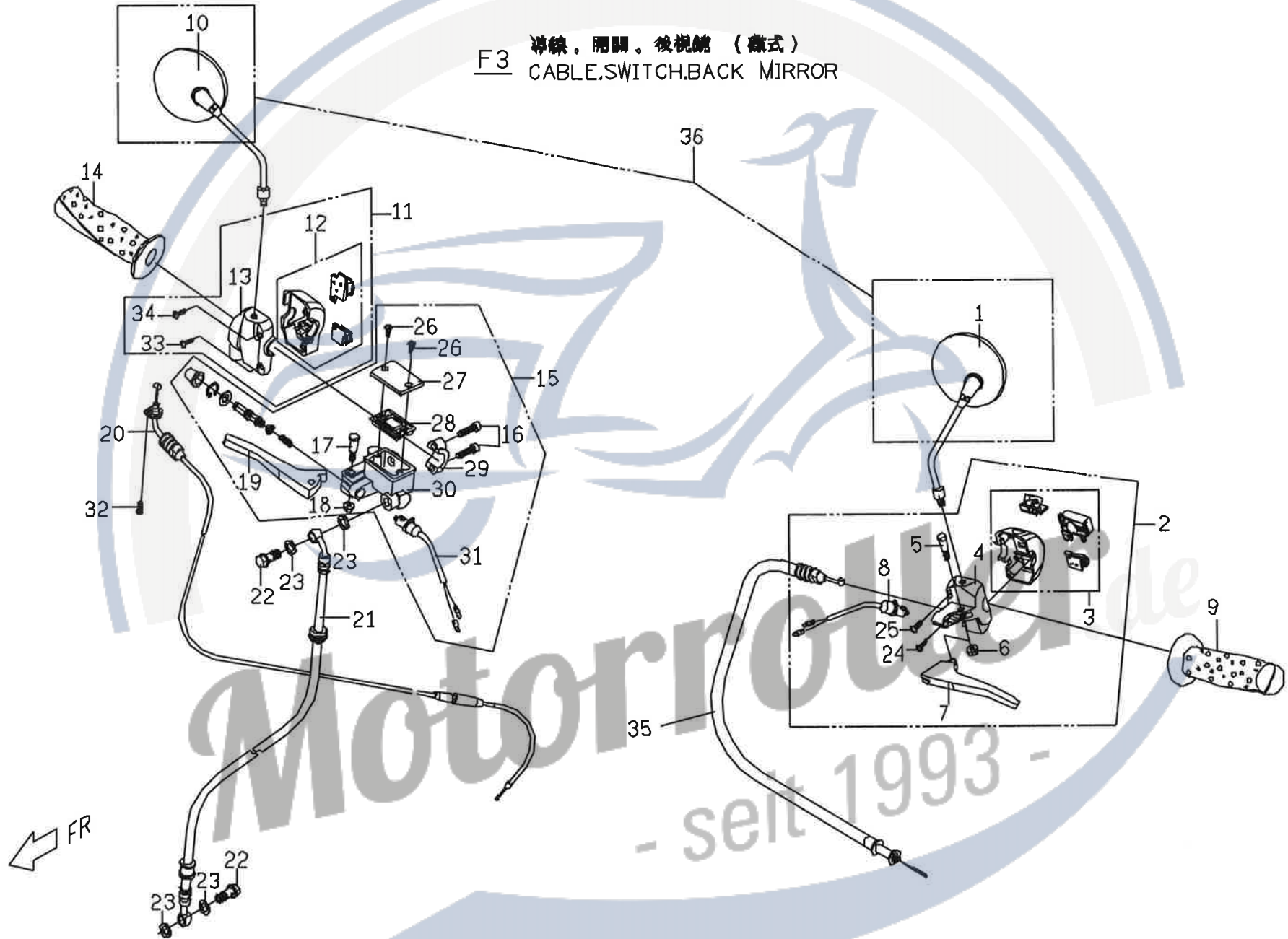

**F3. CABLES, SWITCH**

No.	Part No.	Q'TY	PART NAME	REMARK	FMSP
1	P561F0100001	1	LH BACK MIRROR		
2	P1546003000	1	LEVER HOLDER ASSY(LEFT)		Y
3	P154F410000	1	HOLDER,LEVER UNDER 2 COMP		
4	P154F020000	1	CASE,SWITCH UNDER 1		
5	P154F030000	1	BOLT		
6	P154F040000	1	NUT,SELF LOCK		
7	P1543303000	1	LEVER,LH BRAKE		Y
8	C2548220000	1	STOP SWITCH COMP		
9	P05410010000	1	LH GRIP ASSY		Y
10	P561F0200001	1	RH BACK MIRROR		
11	P1548003000	1	LEVER HOLDER ASSY(RIGHT)		Y
12	P154H190000	1	CASE,SWITCH UNDER 2 COMP		
13	P154H020000	1	CASE,SWITCH UNDER 1		
14	P05420010000	1	RH GRIP ASSY		Y
15	P54030020000	1	FRT BRAKE MASTER CYLINDER		Y
16	P140C250000	2	HEX SOCKET HEAD BOLT		
17	P140C220000	1	BOLT		
18	P140C230000	1	FLANGE NUT		
19	P140C191000	1	LEVER,RH BRAKE		Y
20	90050501200	1	C-R RECESS PAN HD TAPPING SCREW		

**Motorroller.de**  
- seit 1993 -



### F3.CABLES, SWITCH

No.	Part No.	Q'TY	PART NAME	REMARK	FMSP
21	P64036000001	1	FRT BRAKE FLUID HOSE COMP		
22	P14038110000	2	JOINT BOLT,BRAKE HOSE		
23	92141000002	4	PLAIN WASHER		
24	P154F390000	1	SCREW,PAN HEAD		
25	P154F400000	1	SCREW,PAN HEAD		
26	P140C130000	2	SCREW		
27	P140C120000	1	CAP,RESERVOIR		
28	P140C110000	1	DIAPHRAGM,RESERVOIR		
29	P140C240000	1	BRACKET,MASTER CYLINDER		
30	NA	1	MASTER CYLINDER	NOT SUPPLIED	
31	M25480300000	1	SWITCH COMP		Y
32	P5544601000	1	CABLE ASSY,THROT		Y
33	P154H180000	1	C-R ROUND HD TAPPING		
34	P154H170000	1	C-R ROUND HD TAPPING		
35	P65444000002	1	CABLE ASSY. RR BRAKE		
36	P56160000001	1	BACK MIRROR ASSY		Y
37	P140C050000	1	SPRING		
38	P140C030000	1	P SEAL		
39	P140C020000	1	PISTON		
40	P140C040000	1	S SEAL		
41	P140C070000	1	CLIP		
42	P140C080000	1	DUST PROOF ASSY.		

Motorroller.de  
- seit 1993 -

F4 前叉(碟),前土除  
FRONT FORK,FR FENDER

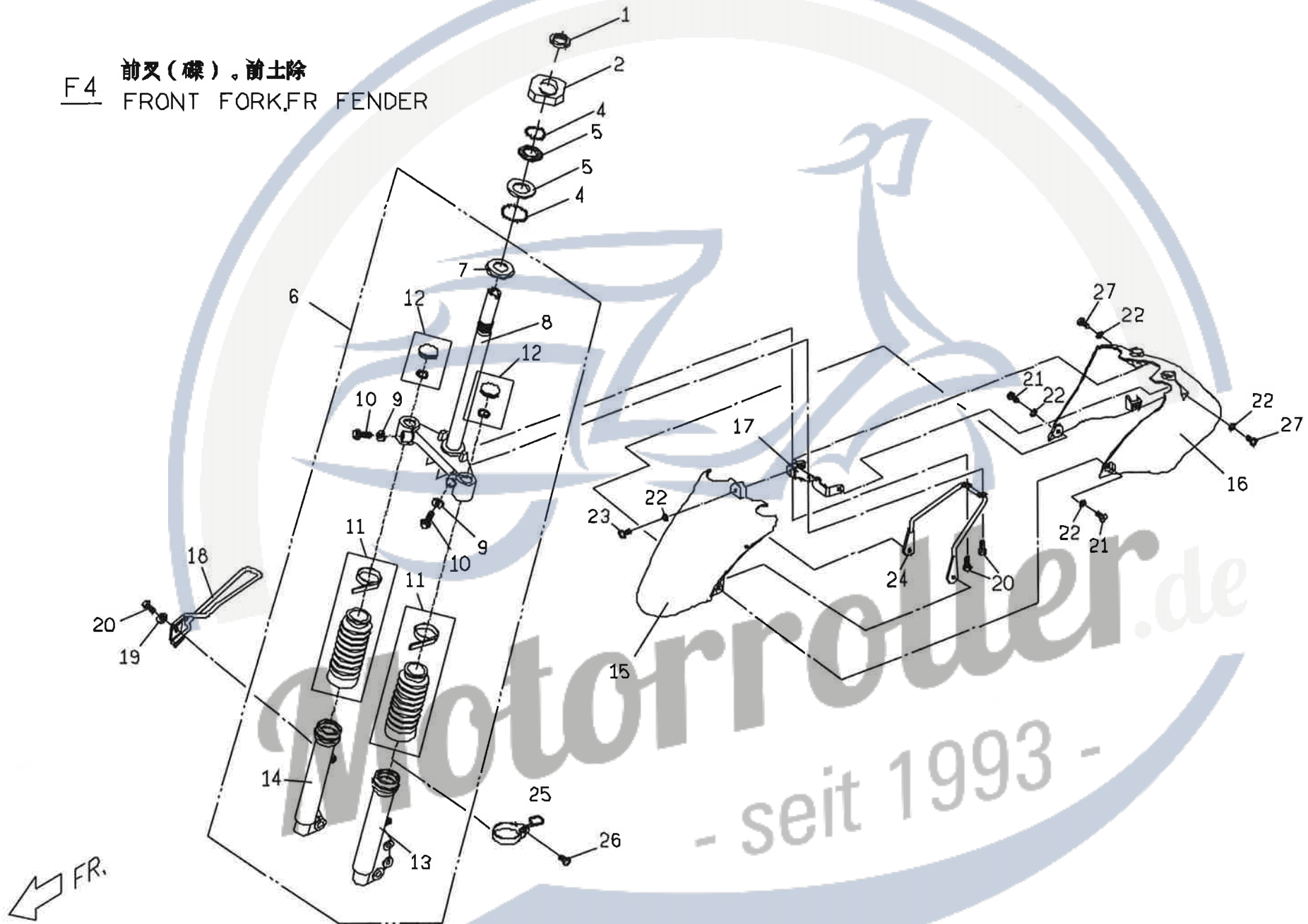

FR.

## F4.1 FRONT FORK

No.	Part No.	Q'TY	PART NAME	REMARK	FMSP
1	P1443040000	1	STEERING SHAFT LOCK NUT		Y
2	P6444051000	1	OUTER BEARING CAGE		Y
3	99010500000	22	BEARING BALL		
4	P1443020000	1	UPPER BEARING CAGE		Y
5	99010500000	22	BEARING BALL		
6	P54430017702	1	FRONT FORK ASSY(DISK)		Y
7	P1443020000	1	LOWER INNER BEARING CAGE		
8	P544C2010001	1	UNDER BRACKET,COMP		
10	P144C030000	2	BOLT		
11	P144C040000	2	COVER,COMP		
12	P544C050000	2	BOLT,COMP		
13	P544C2100002	1	LH OUTER TUBE ASSY	SILVER	
14	P544C2200002	1	RH OUTER TUBE ASSY	SILVER	
15	P5632000690	1	FR SECTION FRONT FENDER (PA50)	BLACK	
16	P5632600650	1	RR SECTION FRONT FENDER		Y
17	P5632010600	1	FRT.FENDER FIXING PLATE		Y
18	E9544021000	1	CABLE CLIP COMP		Y
19	92110800000	1	SPRING WASHER		
20	90190601600	3	HEXAGON FLANGE BOLT		
21	90040601400	2	C-R PAN HD.MACHINE SCREW		
22	92140600005	5	PLAIN WASHER		
23	90040601600	1	C-R PAN HD.MACHINE SCREW		
24	P5632020600	1	FRT.FENDER FIXING FRAME		Y
25	P2403611000	1	BRAKE FLUID HOSE CLIP		
26	90050601002	1	C-R ROUND HD.MACHINE SCREW		
27	90040601000	2	C-R PAN HD.MACHINE SCREW		

F5 輪胎。前輪圈。碟式煞車夾  
TIRE.FRT WHEEL.FRT CALIPER.

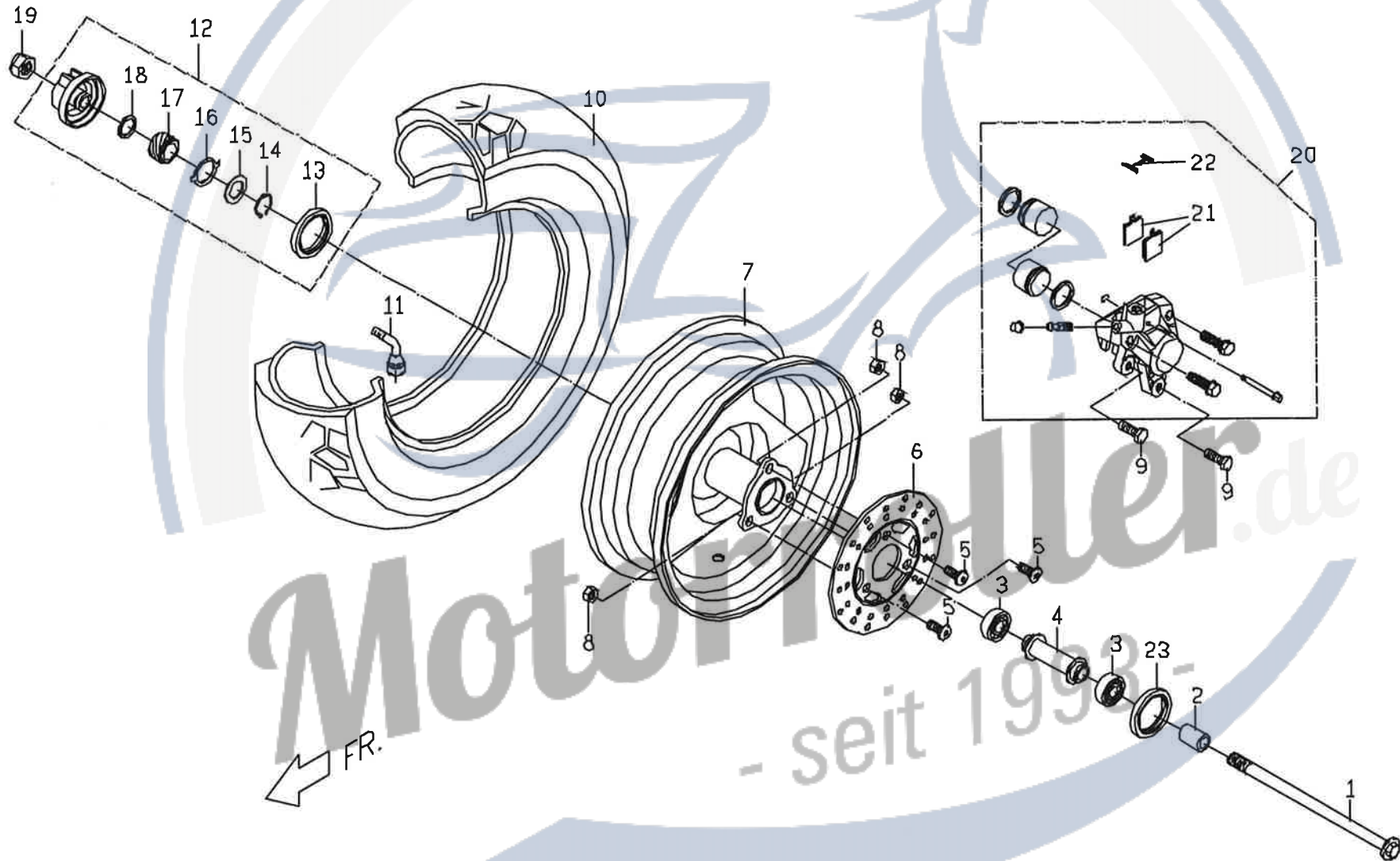



## F5.1 FRONT WHEEL

No.	Part No.	Q'TY	PART NAME	REMARK	FMSP
1	P5402500000	1	AIXL, FR WHEEL		
2	P1401010000	1	SPACER		
3	96520620100	2	ONE SHLIED BALL BEARING		
4	P5402400000	1	SPACER COMP		
5	C1403510000	3	BLOT,FRT BRK DISK	AI RIM(BLACK MAGIC)	
5	E1403512000	3	BLOT,FRT BRK DISK	FOR IRON-RIM	
6	P1403500000	1	DISC FRONT BRAKE		Y
7	P54011037700	1	FRT WHEEL RIM COMP	PA50-SILVER(IRON)	Y
8	92400800001	3	LOCK NUT	ONLY FOR IRON RIM	
9	90190803002	2	HEXAGON HEAD BOLT		
10	P540B320000	1	FRONT WHEEL ASSY ( 90/90-10")		
11	P140B330000	1	VAVLE		
12	C1566002000	1	METER GEAR ASSY		Y
13	95574052600	1	OIL SEAL		
14	92171800000	1	" C "CLIP		
15	92141900001	1	PLAIN WASHER		
16	P1566050000	1	PAD		
17	C1566040000	1	SPEEDMETER GEAR		
18	92141900002	1	PLAIN WASHER		
19	92061200001	1	LOCK NUT		
20	P54033020000	1	FRT BRAKE CLIPPER		Y
21	P540C310000	1	PAD		Y
22	P540C320000	1	YOKE SPRING		
23	95572235700	1	OIL SEAL		

Motorroller.de  
- seit 1993 -

F6.2 BUBU (FOR MOVABLE MODEL)  
WINDSHIELD.FRT INNER COVER.

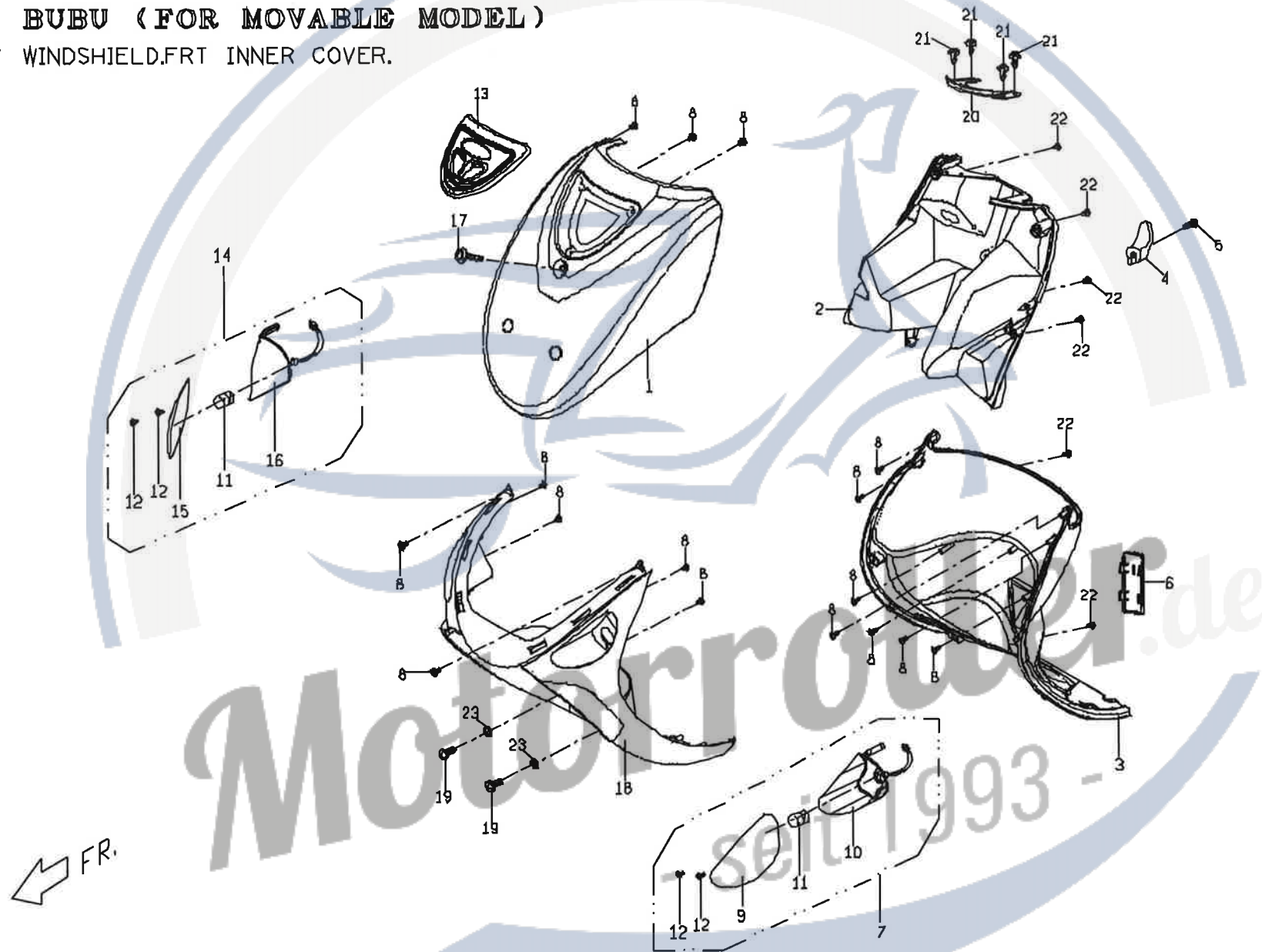

## F6.1 WINDSHIELD

No.	Part No.	Q'TY	PART NAME	REMARK	FMSP
1	P66210026900	1	WINDSHIELD	BLACK	
2	P56230316500	1	FRT INNER COVER,UPPER	BLACK	Y
3	P56230416500	1	FRT INNER COVER,LOWER	BLACK	Y
4	P5701211650	1	FRONT HOOK	BLACK	Y
5	90040602003	1	C-R PAN HD.MACHINE SCREW		
6	P5623010650	1	ADHESIVE PAPER		Y
7	P566C0100003	1	POSITION LAMP,LH		Y
8	90110401200	16	TAPPING SCREW		
9	P566C0200003	1	POSITION LAMP COVER,LH		
11	98211210990	2	BULB (ORANGE)		
12	P566C050000	4	C-R RECESS PAN HD TAPPING SCREW		
14	P566D0100003	1	POSITION LAMP ,RH(WHITE)		Y
15	P566D0200003	1	POSITION LAMP COVER,RH		
18	P56260137J0	1	COVER,FRT LOWER	SILVER	
19	90040601400	2	C-R PAN HD.MACHINE SCREW		
20	P5623020650	1	FRONT PANEL,INNER COVER	BLACK	Y
21	E1701040000	4	SCRIVET COMP		
22	90130501400	6	TAPPING SCREW		
23	92140600005	2	PLAIN WASHER		
24	C2621010000	1	WINDSHIELD,PANEL	CHROME	Y
25	E1621010000	1	SCREW WITH WASHER		

Motorroller.de  
- seit 1993 -





**F7. STEPFLOOR**

No.	Part No.	Q'TY	PART NAME	REMARK	FMSP
1	P66240036500	1	STEP FLOOR	BLACK	
2	90200602500	2	SCREW WITH WASHER		
3	P5583000000	1	BATTERY		
4	C26240326500	1	BATTERY COVER	BLACK	Y
5	90130501400	2	TAPPING SCREW		
6	P6624501000	1	MAT FLOOR		Y
7	P66263007J0	1	LH SIDE COVER	SILVER	
8	90150501601	10	TAPPING SCREW		
9	92370500003	9	SPRING NUT U-TYPE		
10	P66265007J0	1	RH SIDE COVER	SILVER	
11	92140600005	4	PLAIN WASHER		
12	90040601400	4	C-R PAN HD.MACHINE SCREW		
13	C26240217701	1	STEP PLATE,LH REAR		Y
14	C262D0217701	1	STEP PLATE,RH REAR		Y
15	C1583100000	2	GASKET-A ,BATTERY		

**Motorroller.de**  
- seit 1993 -

F8 **BUBU**

BODY COVER, BODY COVER, FRONT  
RR LUGGAGE

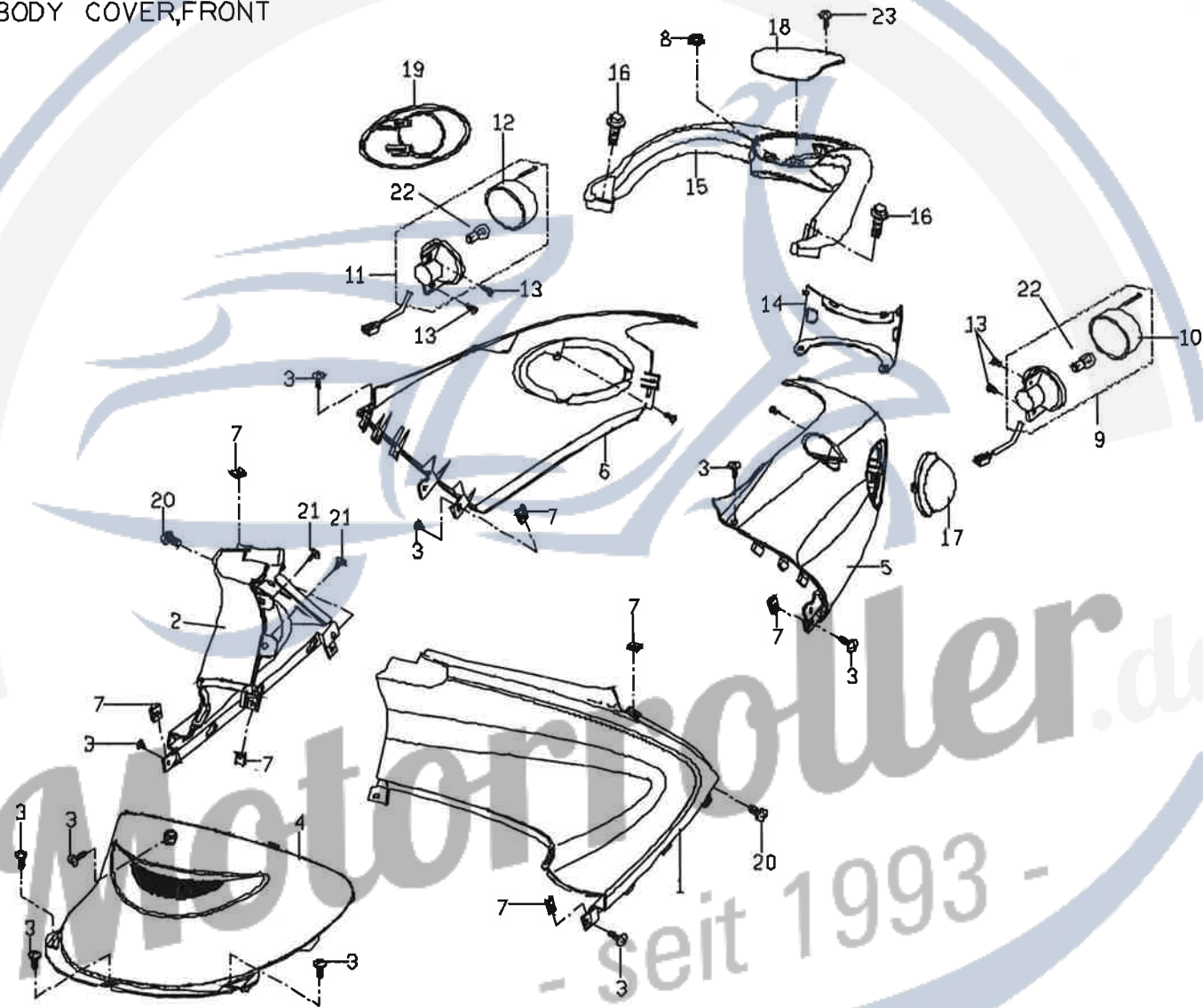

Motorroller.de  
- seit 1993 -

## F8. BODY COVER

No.	Part No.	Q'TY	PART NAME	REMARK	FMSP
1	P662E010650	1	BODY COVER,LH FRONT	BLACK	Y
2	P662E020650	1	BODY COVER,RH FRONT	BLACK	Y
3	90150501601	11	C-R RECESS PAN HD.TAPPING SCREW		
4	P66250116500	1	MIDDLE COVER	BLACK	Y
5	P66253026900	1	LH BODY COVER	SILVER	
6	P66255026900	1	RH BODY COVER	SILVER	
7	92370500003	8	SPRING NUT U-TYPE		
8	92040800000	1	HEXAGON FLANGE NUT		
9	P566G0110002	1	LH RR SIGNAL LAMP ASSY(WHITE)		Y
10	P566G0200002	1	LH RR SIGNAL LAMP COVER(WHITE)		
11	P566H0110002	1	RH RR SIGNAL LAMP ASSY(WHITE)		Y
12	P566H0200002	1	RH RR SIGNAL LAMP COVER(WHITE)		
13	90110401200	4	C-R RECESS PAN HD.TAPPING SCREW		
14	P6625700690	1	REAR COVER	SILVER	
15	P66760007J0	1	RR LUGGAGE BRACKET(SILVER)	SILVER	Y
16	90190802000	2	HEXAG ON FLANGE BOLT		
17	P66256020000	1	LH REAR TURN SIGNAL,INNER COVER	CHROME	Y
18	P6676010000	1	RR LUGGAGE BRAKET COVER		Y
19	P6625F020000	1	RH REAR TURN SIGNAL,INNER COVER	CHROME	Y
20	90040601400	2	C-R RECESS PAN HD.TAPPING SCREW		
21	90130501400	2	C-R RECESS PAN HD.TAPPING SCREW		
22	98211210990	2	BULB, SIGNAL LAMP(ORANGE)		

Motorroller.de  
- seit 1993 -

F9

BUBU

SEAT,LUGGAGE.TOOL KIT.  
LUGGAGE LOW COVER

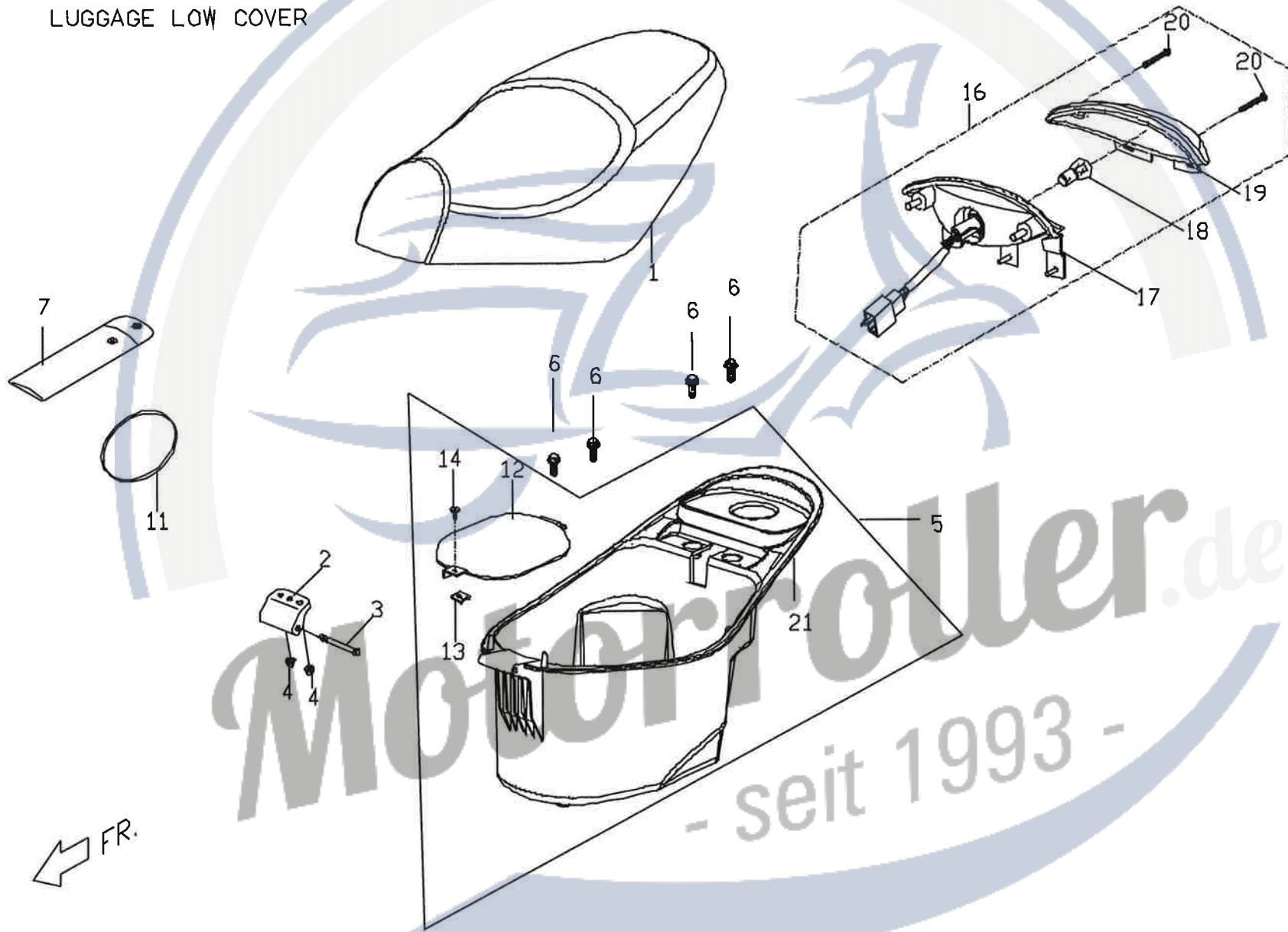



### F9. SEAT, LUGGAGE COMP

No.	Part No.	Q'TY	PART NAME	REMARK	FMSP
1	P6671000000L	1	SEAT ASSY-FULL BLACK	FROM 2009/05	
2	C1681060000	1	BRACKET		
3	C1681070000	1	SPECIAL BOLT		
4	92040600000	2	HEXAGON LOCK NUT		
5	P66810040000	1	LUGGAGE ASSY		
6	90190601600	4	HEXAGON FLANGE BOLT		
7	E9706421000	1	DISMOUNT TOOL COMP		
11	P6701030000	1	O-RING		
12	P668A020000	1	LUGGAGE LOW COVER		
13	92370500003	1	SPRING NUT U-TYPE		
14	90150501601	1	C-R RECESS PAN HD.TAPPING SCREW		
16	P56660000001	1	BACK LAMP ASSY	E-MARK	Y
17	NA	1	LAMP SOCKET	NOT SUPPLIED	
18	98311221051	1	LAMP BULB		
19	P566F010000	1	LENS		
20	P566F050000	2	TAPPING SCREW		

**Motorroller.de**  
 - seit 1993 -



### F10. LICENCE PLATE, LAMP

No.	Part No.	Q'TY	PART NAME	REMARK	FMSP
1	P56360046500	1	LICENCE PLATE	BLACK	Y
2	90150501601	2	TAPPING SCREW		
3	92370500003	2	SPRING NUT U-TYPE		
4	90130501400	1	TAPPING SCREW		
5	90040601400	1	C-R RECESS PAN HD TAPPING SCREW		
6	92140600005	1	WASHER		
7	E1701040000	2	SCRIVET COMP		
8	P56690010000	1	REFLECTOR		
9	92020500000	1	HEXAGON NUT		
10	92140500014	1	WASHER		
11	P5666900000	1	LICENCE LAMP ASSY		Y
12	P566F910000	1	LAMP COVER		
13	NA	1	SOCKET	NOT SUPPLIED	
14	NA	1	PACKING	NOT SUPPLIED	
15	P566F940000	2	TAPPING SCREW		
16	P566F950000	1	CONNECTING WIRE		
17	P566F960000	1	BULB		
18	90110401200	2	TAPPING SCREW		
19	P6636010650	1	LICENCE PLATE LOWER PART	BLACK	Y
20	90110401200	3	TAPPING SCREW		

Motorroller.de  
- seit 1993 -

F11 BUBU  
FUEL TANK

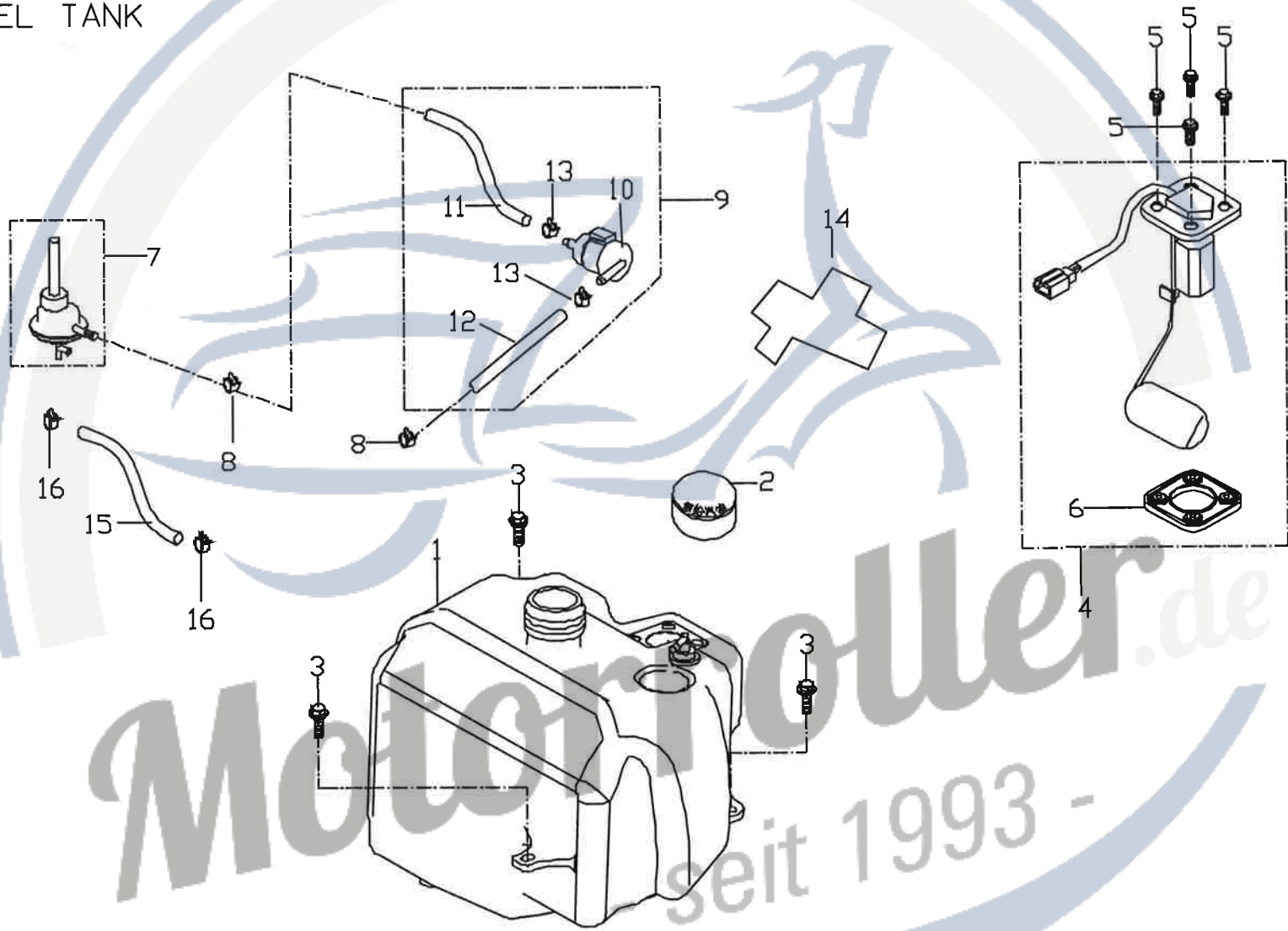

FR.

Motoroller.de  
seit 1993 -



**F11. FUEL TANK**

No.	Part No.	Q'TY	PART NAME	REMARK	FMSP
1	P65210000001	1	FUEL TANK		
2	E1521302000	1	TANK COVER ( WITHOUT EEC )		Y
3	90190601502	3	HEXAGON FLANGE BOLT		
4	P6521700000	1	FUEL GAUGE COMP		Y
5	90180501600	4	HEXAGON FLANGE BOLT		
6	C152A090000	1	HEXAGON LOCK NUT		
7	P6523000000	1	AUTO COCK COMP		Y
8	92220800001	2	CLIP		
9	P65212000003	1	FUEL FILTER ASSY		Y
10	P65212100001	1	FUEL FILTER		
11	P652A0200003	1	OIL HOSE ( A )		
12	P652A0300003	1	OIL HOSE ( B )		
13	92220900001	2	CLIP		
14	P6706011000	1	BRACKET, FUEL FILTER		
15	P65260300001	1	VACUUM PIPE		

**Motorroller.de**  
- seit 1993 -

F12.1 車 架  
FRAME (FOR BUBU50)

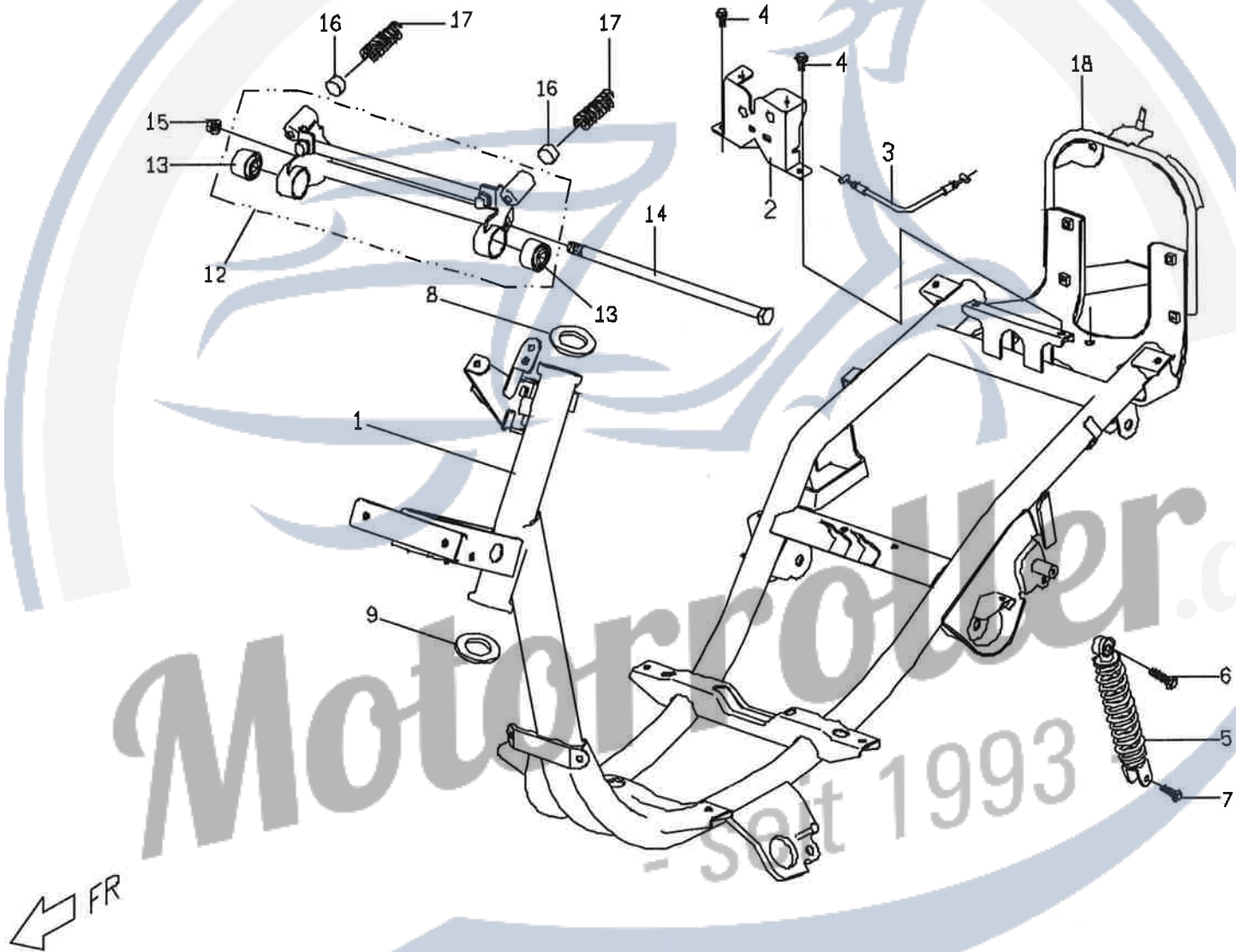

**F12.1 FRAME**

No.	Part No.	Q'TY	PART NAME	REMARK	FMSP
1	P64210046002	1	FRAME COMP		
2	ES671300000	1	SEAT LOCK COMP		Y
3	P5671121000	1	SEAT LOCK LEVER CABLE		Y
4	90190601502	2	HEXAGON FLANGE BOLT		
5	P64810020000	1	CUSHION ASSY,RR. (black)	BLACK	Y
6	90191004000	1	HEXAGON FLANGE BOLT		
7	90190803201	1	HEXAGON FLANGE BOLT		
12	C14860010001	1	ENGINE HANGER COMP		Y
13	C1486050000	2	RUBBER,DAMPER		
14	90021229600	1	HEXAGON BOLT		
15	92061000001	1	LOCK NUT		
16	E1486040000	2	RUBBER,DAMPER		
17	E1486050000	2	SPRING		
18	P64215016000	1	FUEL TANK BRACKET		
22	P6701020000	1	WATER RESISTANT RUBBER		
23	P64260600003	1	VIN PLATE		
25	P6421411600	1	BRACKET, WINDSHIELD		Y

**Motorroller.de**  
- seit 1993 -

F13 **BUBU**  
WIRE HARNESS

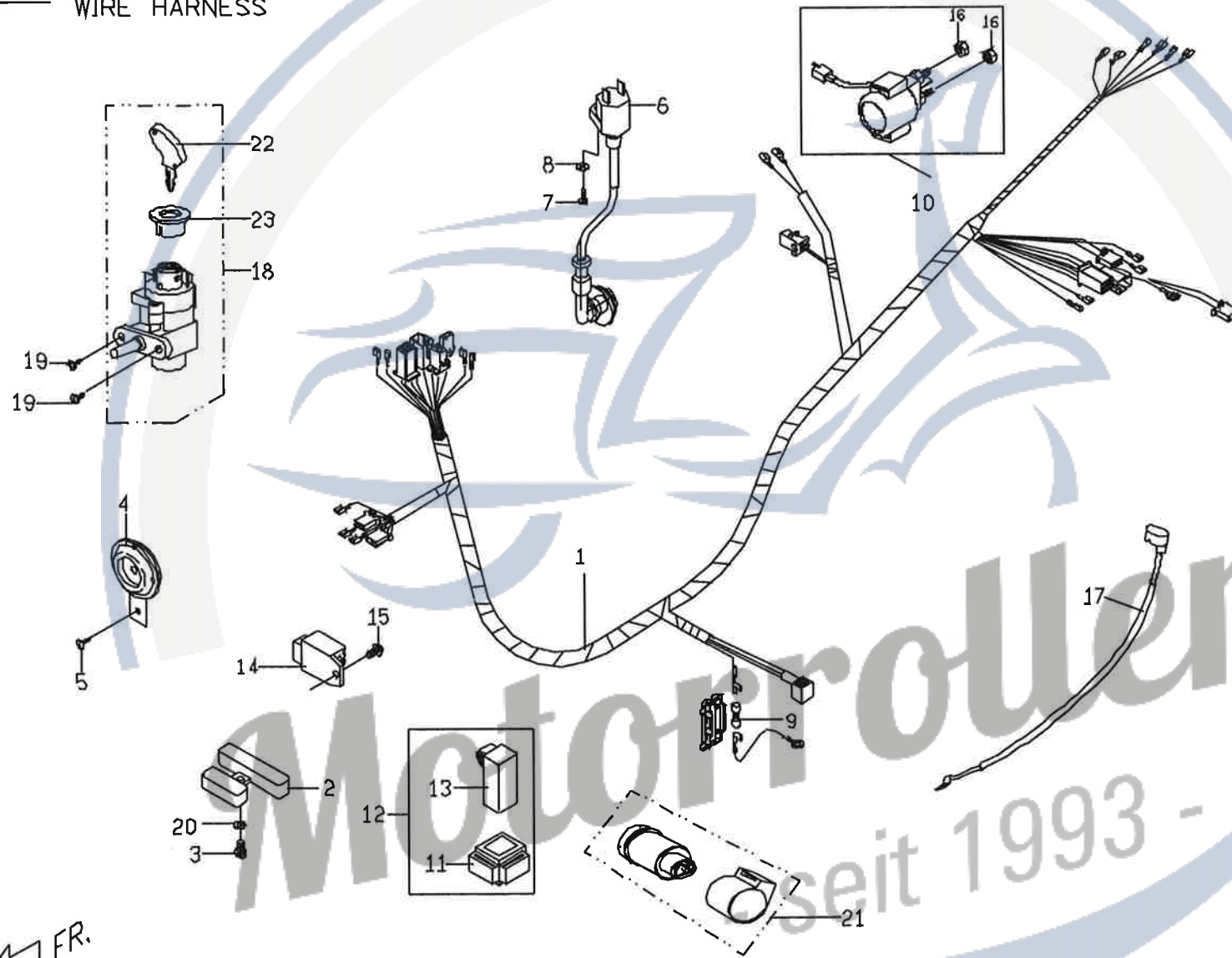

← FR.



### F13.1 WIRE HARENESS

No.	Part No.	Q'TY	PART NAME	REMARK	FMSP
1	P65816030002	1	WIRE HARNESS		Y
2	P1586600000	1	RESISTOR		Y
3	90190601200	1	HEXAGON FLANGE BOLT		
4	P5583600000	1	HORN		Y
5	90040601400	1	C-R MACHINE HD,TAPPING SCREW		
6	C15846010001	1	COIL COMP,IGNITION		Y
7	90070502000	1	C-R MACHINE HD,TAPPING SCREW		
8	92110500000	1	SPRING LOCK WASHER		
9	E1581630000	1	FUSE		
10	P9581000000	1	STARTER RELAY AND SUPPORTOR		Y
11	P1701190000	1	RUBBER BRACKET		
12	NA	1	CDI UNIT COMP		
13	E9582000000	1	CDI UNIT		Y
14	C1584000000	1	VOL REGULATOR COMP		Y
15	90190602000	1	HEXAGON FLANGE BOLT		
16	92030600004	2	HEXAGON NUT		
18	P5552002000	1	IGNITION SWTTCH ASSY		Y
19	90040601600	2	C-R MACHINE HD,TAPPING SCREW		
20	92140600005	1	WASHER		
21	P2586011000	1	FLASHER RELAY ASSY		Y
22	ES55B010000	1	KEY,BLANK		
23	P555B020000	1	INDICATOR PLATE		

Motorroller.de  
- seit 1993 -

F14 機油箱

OIL TANK

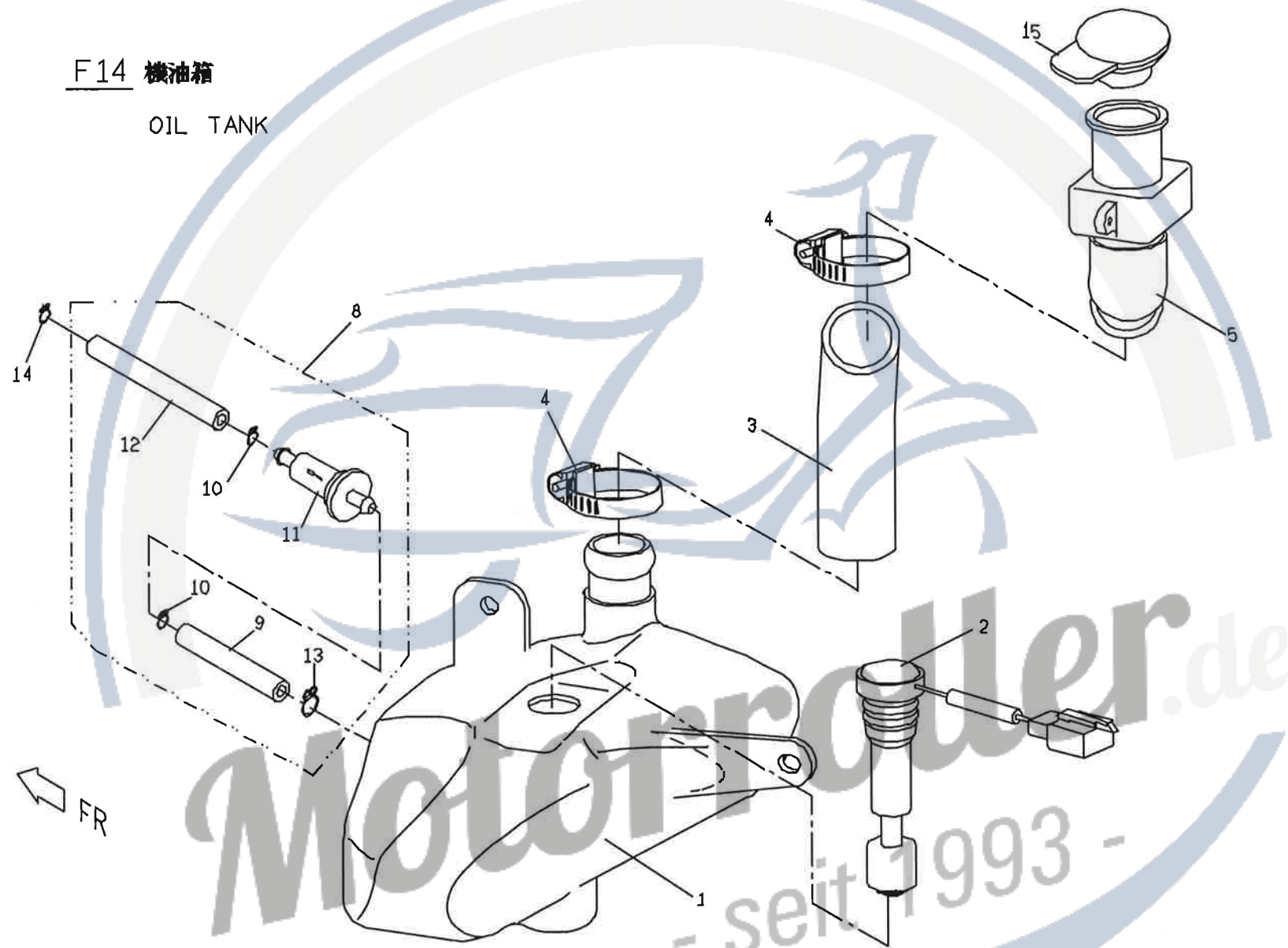

**F14. OIL TANK**

No.	Part No.	Q'TY	PART NAME	REMARK	FMSP
1	P6522501000	1	OIL FUEL		Y
2	P5522700000	1	OIL GAUSE COMP.		Y
3	P65225210002	1	OIL FUEL TRANSMSSION HOSE		
4	P5706270000	1	CLIP		
5	P5522512000	1	OIL FUEL TANK		
6	P65225300002	1	FIXED PLATE,FUEL TANK		
7	90110401200	2	C-R RECESS PAN HD.TAPPING		
8	P6522200000	1	OIL CLEAN ASSY		Y
9	NA	1	OIL FUEL TRANSMSSION HOSE		
10	92200700000	2	HOSE CLAMP		
11	E152B000000	1	OIL CLEAN		
12	NA	1	OIL FUEL TRANSMSSION HOSE		
13	92200700000	1	HOSE CLAMP		
14	92200700000	1	HOSE CLAMP		
15	P1522300000	1	OIL TANK COVER		Y
16	P5706280000	1	CLIP		

**Motorroller.de**  
- seit 1993 -

# F15. LABELS



— 1



— 2



— 3

*Ligero 50*

— 10

Motorroller.de  
- seit 1993 -



**F15. LABELS**

No.	Part No.	Q'TY	PART NAME	REMARK	FMSP
1	C16030010001	1	"NOTICE"LABEL		
2	C2601010000	1	PGO SCOOTERS PAPER		
3	P1603040000	1	FUEL TYPE LABEL		
10	P6601240000	2	LIGERO 50 LABEL, MOVABLE		



**Motorroller.de**  
- seit 1993 -